

GROUP 1 FRONT END

SECTIONS IN GROUP 1

Section	Subject	Page	Section	Subject	Page
1-A	Windshield Assembly	1-1	1-C	Instrument Panel Assembly....	1-27
1-B	Windshield Wiper and Washer Assembly.....	1-7	1-D	Shroud panel and ventilating system.....	1-29

SECTION 1-A WINDSHIELD ASSEMBLY

CONTENTS OF SECTION 1-A

Paragraph	Subject	Page	Paragraph	Subject	Page
1-1	Windshield Garnish Mouldings Rear View Mirror Support, Sunshade Support.....	1-1	1-2	Windshield Reveal Mouldings....	1-2
			1-3	Windshield Glass.....	1-4

1-1 WINDSHIELD GARNISH MOLDINGS—REAR VIEW MIRROR SUPPORT SUNSHADE SUPPORT

a. Description

The windshield garnish moldings consist of an upper right and left, side right and left and lower right and left moldings. The upper and side moldings are installed after the lower moldings.

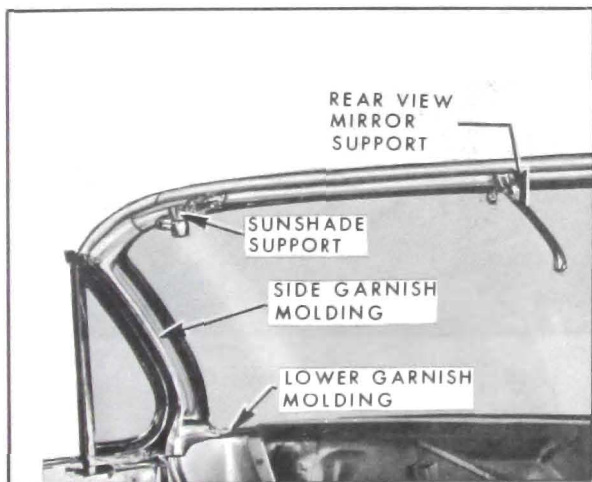

Figure 1-1—Windshield Garnish Mouldings

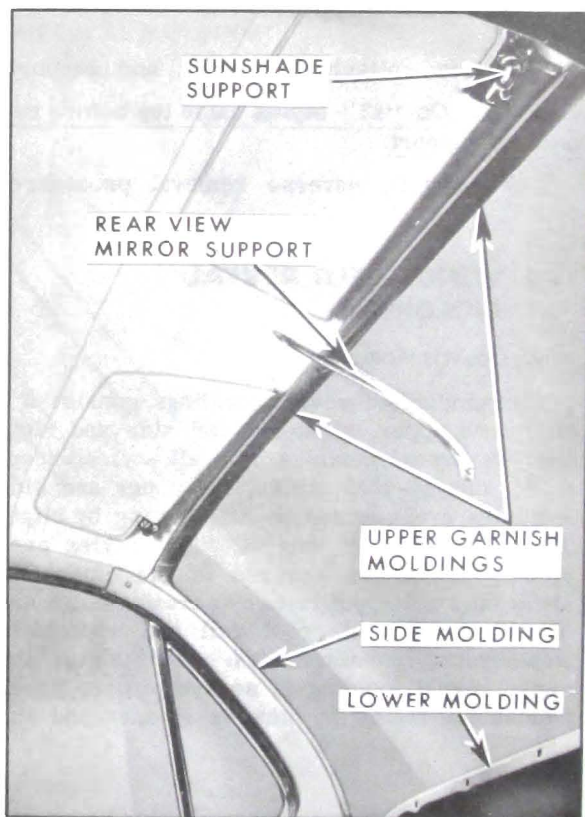

Figure 1-2—Windshield Garnish Mouldings

b. Removal and Installation of Garnish Moldings

1. Place protective covering over front seat and instrument panel.
2. Remove moldings in following order: side, lower and upper moldings.

NOTE: On "67" styles remove windshield pillar weatherstrip retainers and side reveal moldings prior to removal of side garnish moldings. Remove sunshade supports prior to removal of upper garnish moldings.

3. To install, reverse removal procedure.

c. Removal and Installation of Rear View Mirror Support

1. Remove one side of upper windshield garnish molding.
2. Remove support attaching screws and slide to one side and remove.
3. To install, reverse removal procedure.

d. Removal and Installation of Sunshade Support

1. Remove attaching screws and support.
- NOTE: On "67" styles raise top before removing support.
2. To install, reverse removal procedure.

1-2 WINDSHIELD REVEAL MOLDINGS

a. Description

The windshield reveal moldings consist of a one piece upper, right and left side and right and left lower moldings. On all styles except "67" and 44-4639 styles, the upper and side moldings are secured to the opening by clips. The side moldings on the "39" styles previously listed are secured to the windshield pillar and side roof rails by screws, which are hidden by the side roof rail and windshield weatherstrip retainer. On "67" styles the upper reveal molding is secured to the upper windshield frame by screws at each end and

studs and nuts in the center. The side moldings on "67" styles are secured to the windshield pillars by screws. The lower moldings on all styles are secured by screws through the molding clips into the shroud upper assembly.

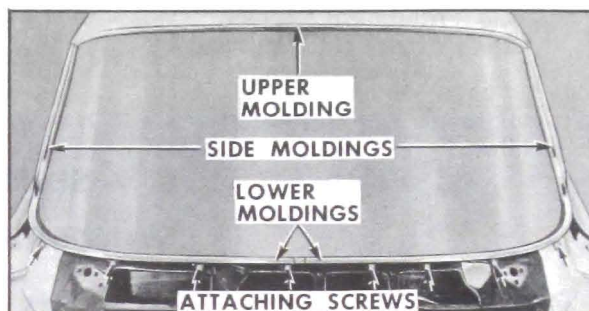

Figure 1-3—Windshield Reveal Moldings

b. Removal of Reveal Molding

1. Place protective covering over hood and front fenders.
2. Remove windshield wiper arms, escutcheon nuts and escutcheons.
3. Remove air intake grille attaching screws (Figure 1-4).

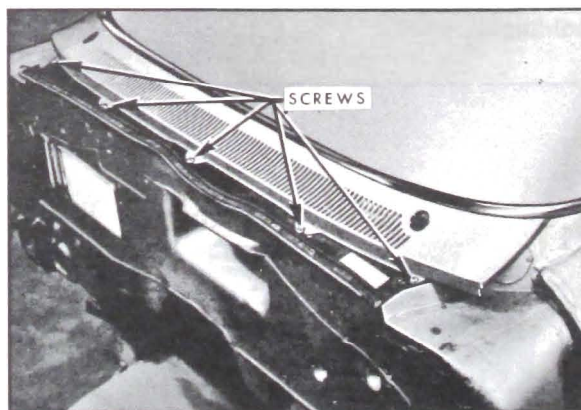

Figure 1-4—Air Intake Grille

4. Lift up grille and slide forward to remove.

CAUTION: Care should be exercised to make certain grille does not contact hood, chipping paint.

5. Remove lower reveal molding attaching screws (Figure 1-3) and remove the molding.

6. On all styles except "67" styles and "39" styles listed, tool No. J-7898-01 may be used to remove the side and upper reveal moldings. When using reveal molding removing tool No. J-7898-01 carefully lift up upper end of reveal molding sufficiently to engage point of tool between molding and molding clip as indicated in

Figure 1-5; swing tool slightly as indicated in illustration, to disengage prongs of clip from molding and lift molding free of clip. Repeat this operation at each molding clip.

NOTE: In some instances a flat-bladed tool such as a putty knife or equivalent may be used to pry the moldings from the opening. Care should be exercised when removing moldings to eliminate any damage to the moldings or body paint, etc.

7. On all 44-4639 styles the side reveal moldings are secured by screws at the pillar and roof rail and it is necessary to loosen the roof rail and windshield pillar weatherstrip to

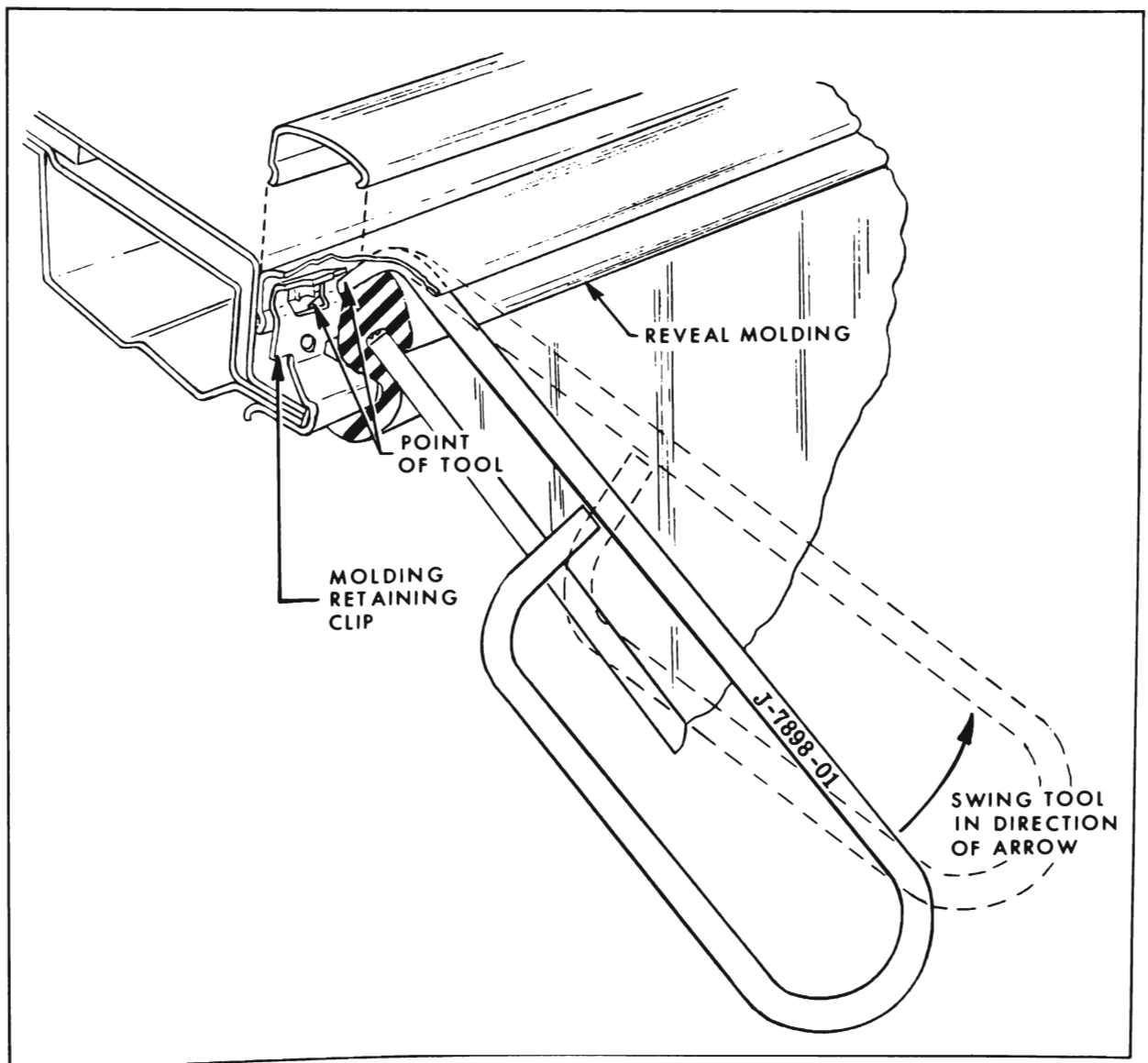

Figure 1-5—Reveal Molding Removing Tool

gain access to the screws. Remove screws and carefully remove the molding from the opening. On "67" styles, the side moldings are secured by screws only. Raise top, loosen windshield pillar weatherstrip retainer, remove attaching screws and molding.

8. On all styles except "67" styles, carefully remove the upper reveal molding with tool No. J-7898-01 (Figure 1-5) or flat-bladed tool as required. On "67" styles, remove screws at outer ends of molding, then remove upper garnish molding to gain access to stud nuts. Remove nuts and molding.

c. Installation of Reveal Moldings

Make certain there is sufficient sealer in cavity between windshield rubber channel and body. If sealer is required, apply necessary medium-bodied sealer.

1. Upper Reveal Moldings. On all styles except "67" styles, snap upper reveal molding in place. On "67" styles, seal attaching studs and holes and install molding.

2. Side Reveal Molding. On "39" and "67" styles, seal attaching screw holes and install moldings.

3. On "39" and "67" styles, seal side roof rail and windshield pillar weatherstrips and retainers and install.

4. Install lower reveal molding and previously removed hardware parts.

1-3 WINDSHIELD GLASS

a. Removal of Windshield Glass

1. Place protective covering over front seat and instrument panel.

2. Place protective covering over hood and front fenders.

3. Remove garnish moldings.

4. Remove windshield wiper arms, escutcheon nuts and escutcheons.

5. Remove shroud top ventilator grille.

6. Remove windshield reveal moldings.

NOTE: If glass is broken or cracked, mark centerline of glass and body, so alignment of glass to body opening may be checked to locate

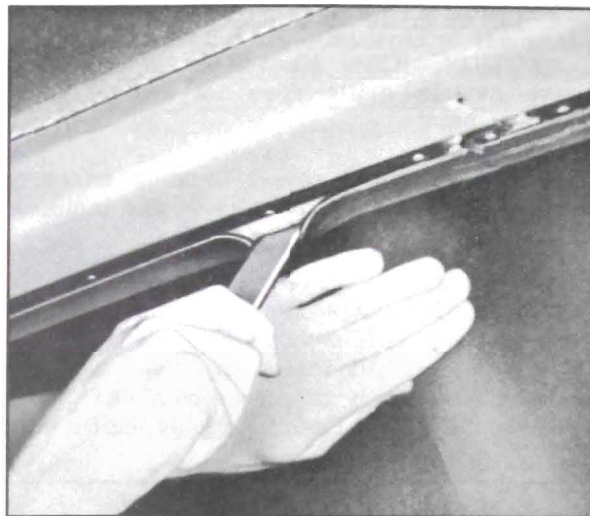

Figure 1-6—Windshield Glass Removal

cause of glass break (glass off center, strain break, etc.).

7. On inside of body loosen lip of rubber channel from pinchweld flange along top and sides of windshield as follows: With palm of hand, apply pressure to glass near edge (Figure 1-6); at same time, use a blunt putty knife or other suitable tool and carefully assist rubber channel over pinchweld flange.

8. After windshield channel is free from pinchweld flange, with aid of helper, carefully lift windshield assembly from opening and place on a protected bench.

b. Checking Body Windshield Opening

It is important that the body windshield opening be checked thoroughly before installation of a replacement windshield glass. The following procedure outlines the method which may be used to check the windshield opening.

1. Remove the windshield from body.

2. Check windshield rubber channel for any irregularities.

3. Clean off old sealer around windshield opening and check entire body opening flange for any irregularities.

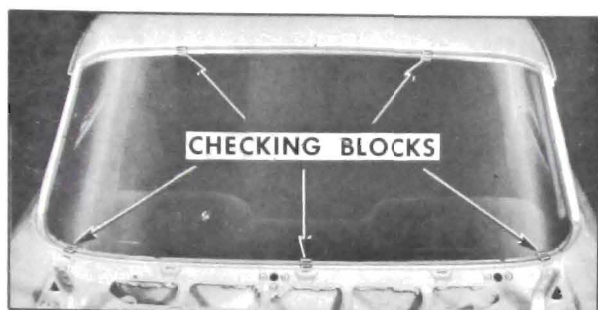

Figure 1-7—Windshield Checking

4. Install five (5) windshield checking blocks to pinchweld flange (Figure 1-7). Position one (1) block over lower pinchweld flange on each side of body twelve inches (12'') inboard from the lower corner of windshield opening. Position one (1) block over upper pinchweld flange midway between center block and each outboard block on lower retaining flange.

5. With aid of helper, carefully position replacement glass on blocks in windshield opening.

CAUTION: Care should be exercised to make certain glass does not strike body metal during installation. Edge chips can lead to future breaks.

6. With windshield supported and centered in the body opening by checking blocks, check relationship of glass to body opening around entire perimeter of glass. Figure 1-8 shows a typical section taken through the glass channel and body opening. Check glass to body relationship as follows:

a. The inside surface of glass should be uniform distance from pinchweld flange. The dimension should be from 1/4'' to 5/16''.

b. The outer edge of glass should be a uniform distance from body metal, measured in plane of the glass. This dimension should be from 5/16'' to 3/8''.

NOTE: Windshield checking blocks (J-8942) may be used as shown in Figure 1-7.

7. Mark any sections of body to be re-formed, remove glass and re-form opening as required.

8. Recheck windshield opening as outlined above. Then mark the center line on the glass and body so that glass can be accurately centered in the opening when installed.

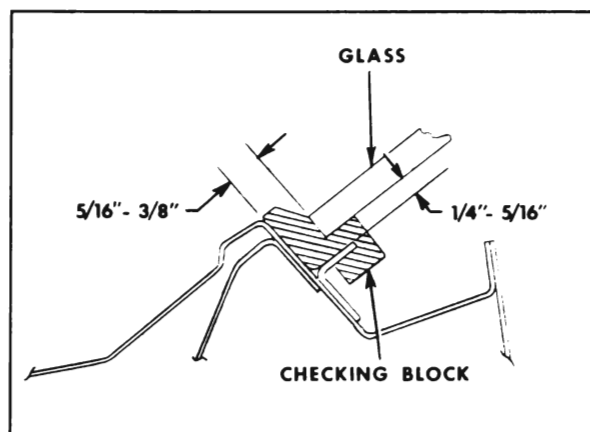

Figure 1-8—Windshield Opening Check

c. Installation of Windshield Glass

1. Clean out old sealer in glass cavity of windshield rubber channel and around base of rubber channel.

2. Install rubber channel to glass.

3. Install a strong cord in pinchweld cavity of rubber channel completely around windshield. Tie ends of cord and tape to inside surface of glass at bottom center of glass (Figure 1-9).

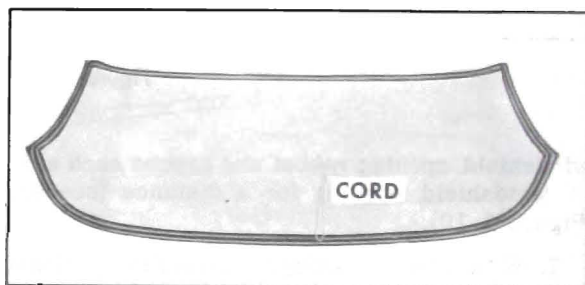

Figure 1-9—Windshield Installation

4. Apply a ribbon of medium-bodied sealer completely around base of rubber channel (see #1, Figure 1-10).

5. Inspect condition of each molding clip, install new clips where necessary, make certain clips are properly sealed to pinchweld and body (see #2, Figure 1-10) except "67" styles.

6. Apply a bead of medium-bodied sealer approximately 1/4'' in diameter to corner of

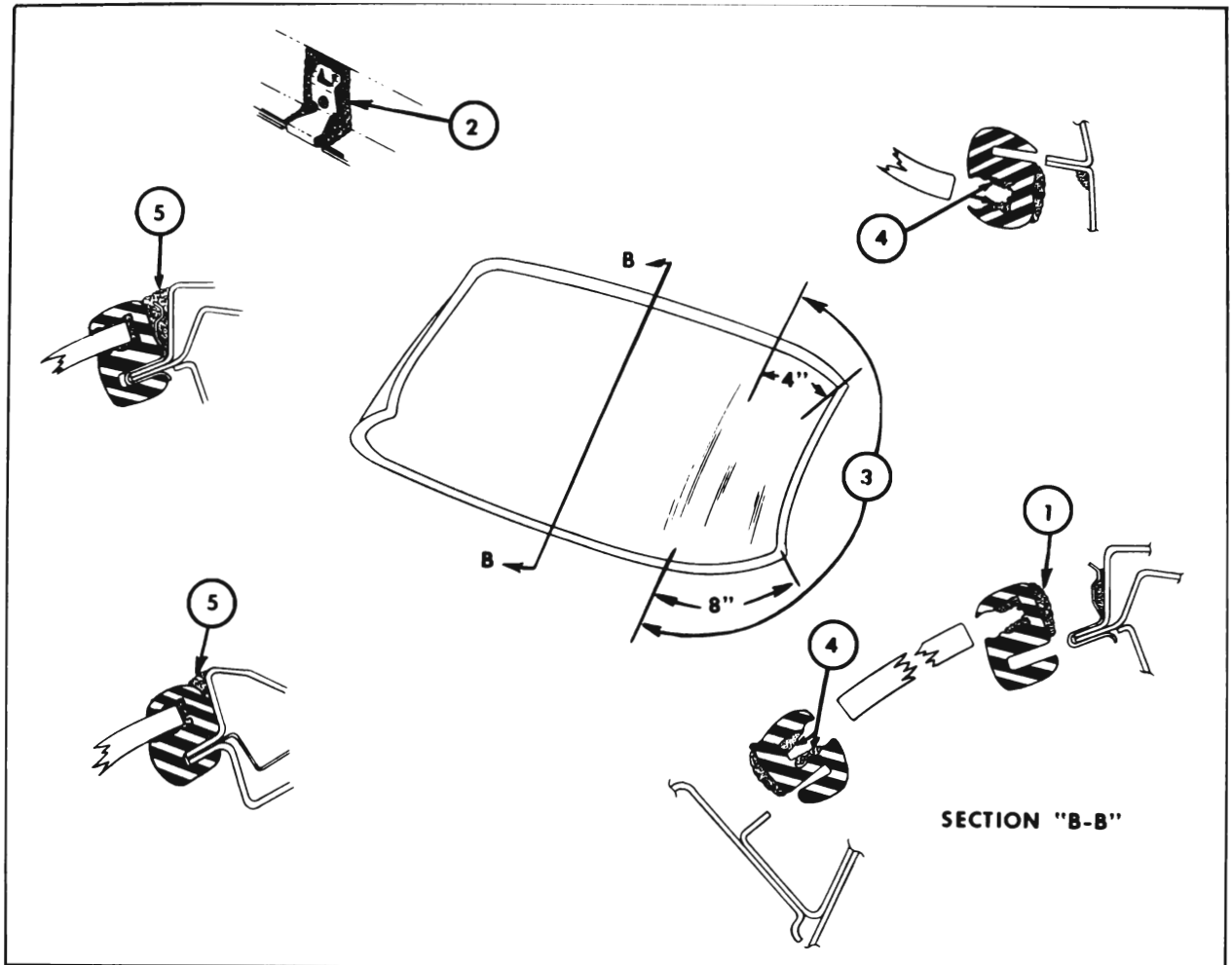

Figure 1-10—Windshield Sealing

windshield opening rabbet and around each side of windshield opening for a distance (see #3, Figure 1-10).

7. With aid of helper, carefully position and center windshield assembly in windshield opening.

CAUTION: Do not position by tapping or hammering glass at any time.

8. When the glass and channel are properly positioned in the opening, slowly pull both ends of cord starting at lower center of windshield, to seat lip of rubber channel over pinchweld flange. Cord should be pulled first across bottom of windshield, then up each side and finally across top of windshield.

9. Using a pressure type applicator, seal inner and outer lips of rubber channel to glass with an approved weatherstrip adhesive (see #4, Figure 1-10). Seals are to extend completely around rubber channel.

10. Clean off excess sealer from windshield glass.

11. On outside of windshield apply medium-bodied sealer between windshield rubber channel and opening across top and sides (see #5, Figure 1-10).

12. Reinstall all previously removed parts and remove protective coverings.