

## SECTION 11-E

# VACUUM TRUNK RELEASE

### 11-22 Vacuum Trunk Lid Release

The vacuum operated trunk release is available as a factory and dealer installed accessory on all models except Estate Wagons.

The control lever for the vacuum lid release is located in the glove compartment. Pulling the actuator lever creates a vacuum to operate

the power unit located in the rear compartment lock mechanism to unlock the trunk latch.

In the event the vacuum operated latch fails, the rear compartment may be unlocked with the key in the conventional manner.

Figures 11-141, 11-142, 11-143 and 11-144 show the installation of the vacuum trunk release.

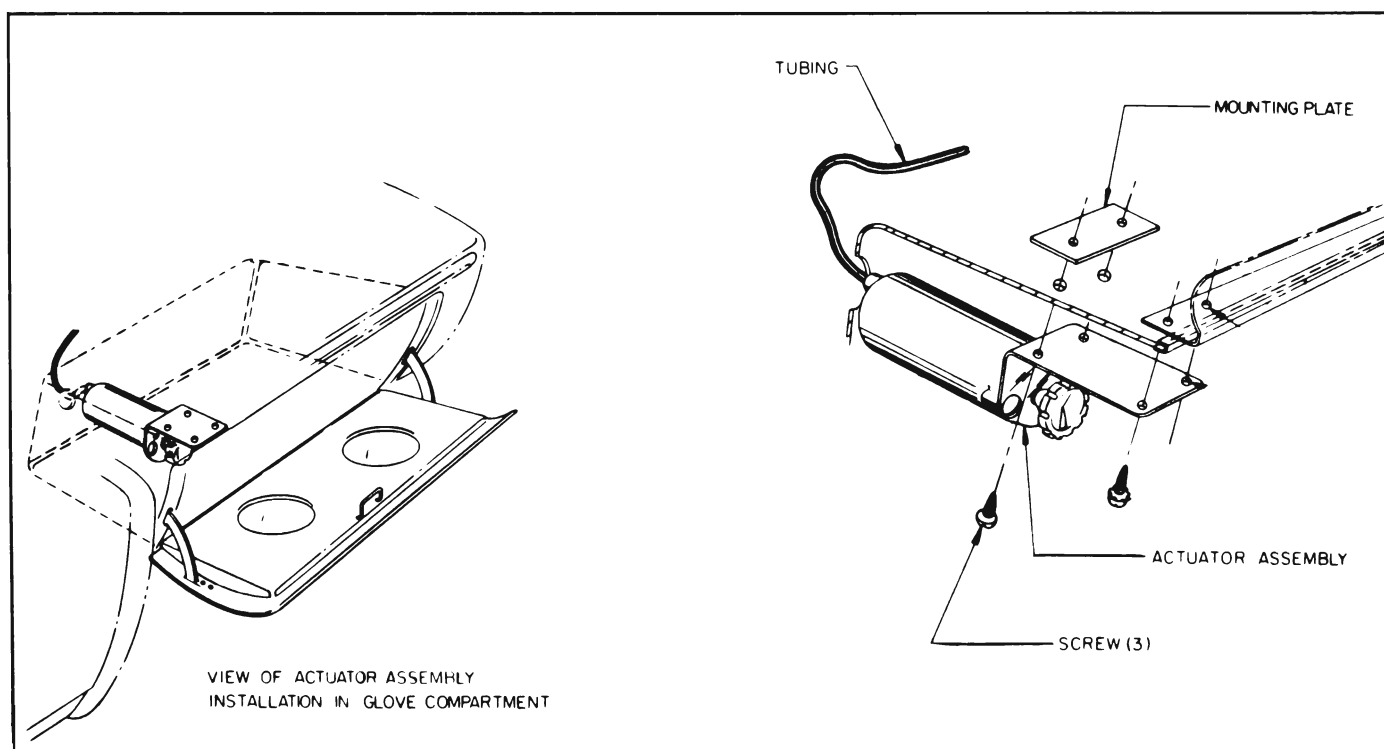

Figure 11-141—Actuator Installation

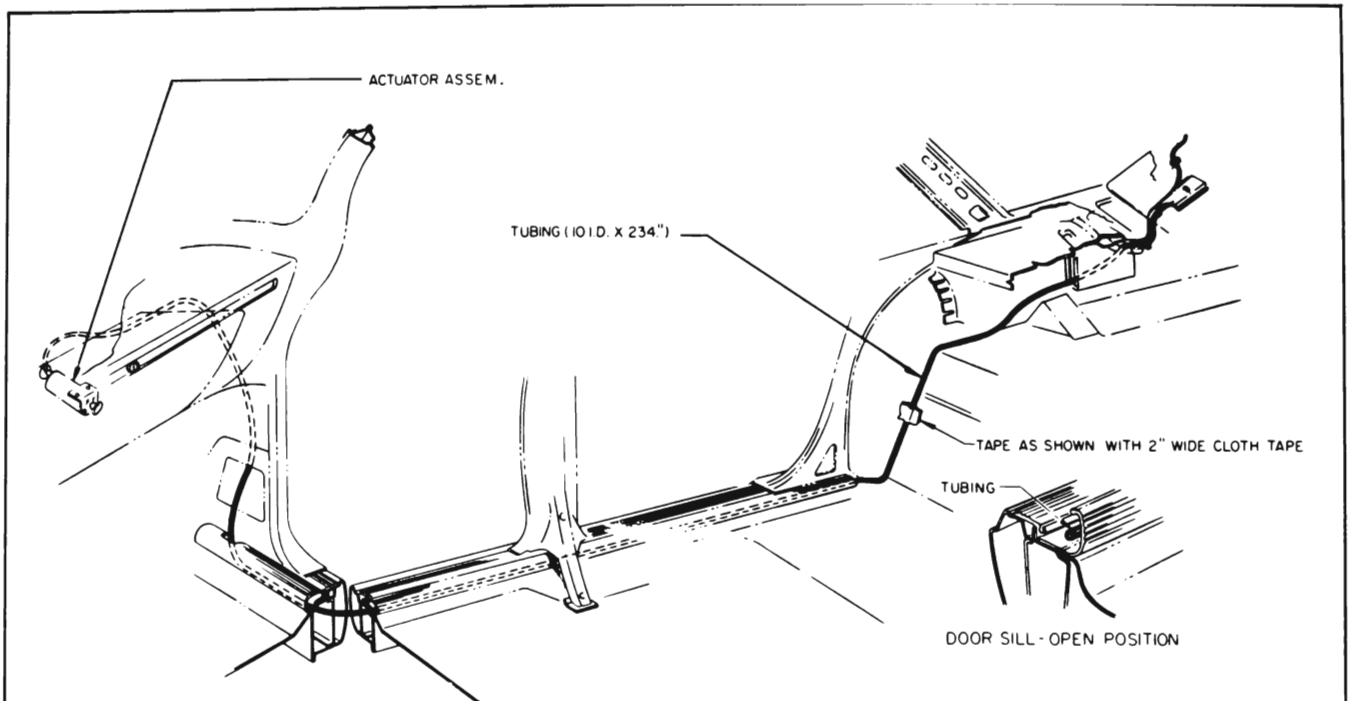

Figure 11-142—Vacuum Hose Routing at Body Door Sill

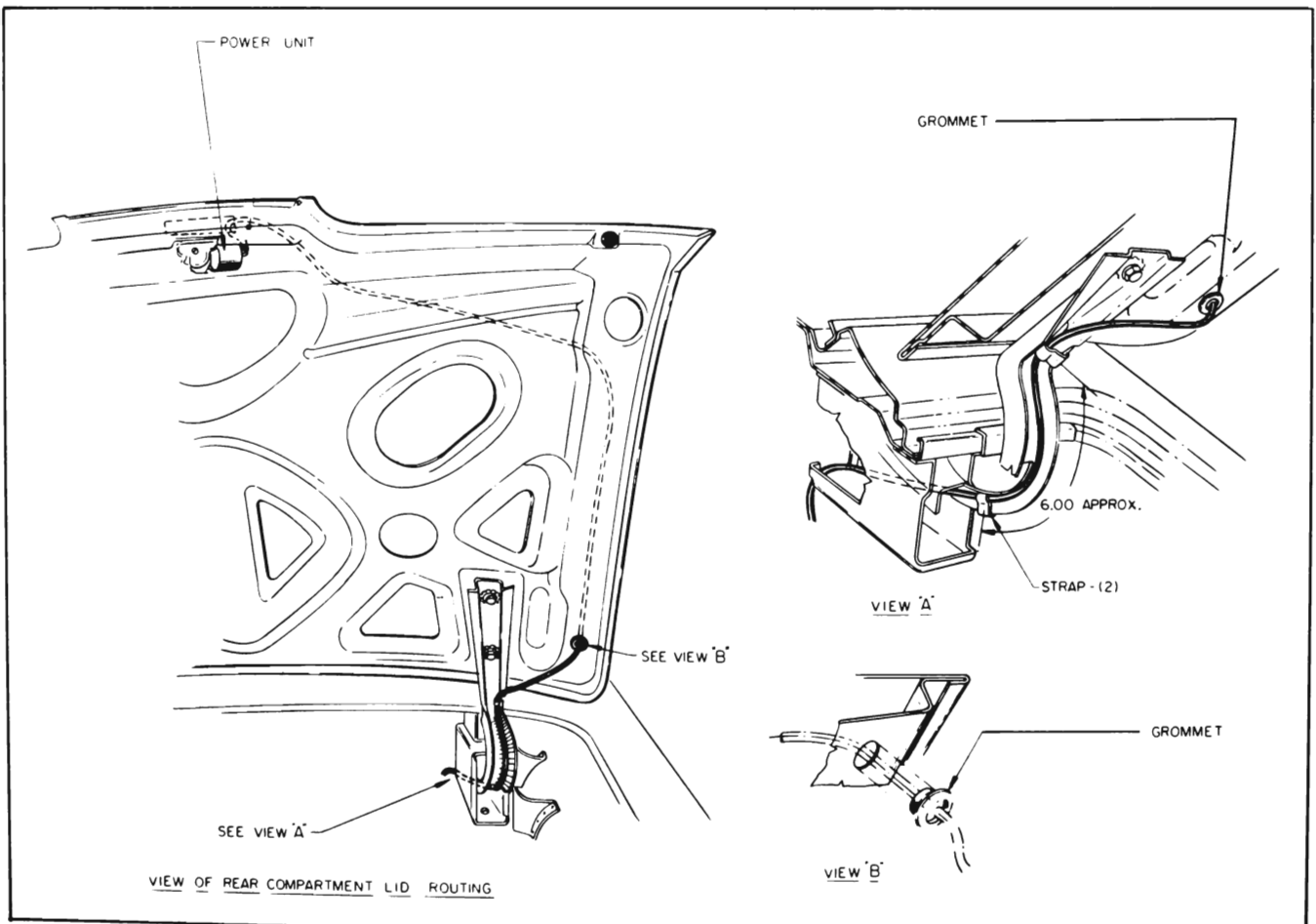

Figure 11-143—Vacuum Hose Routing at Trunk

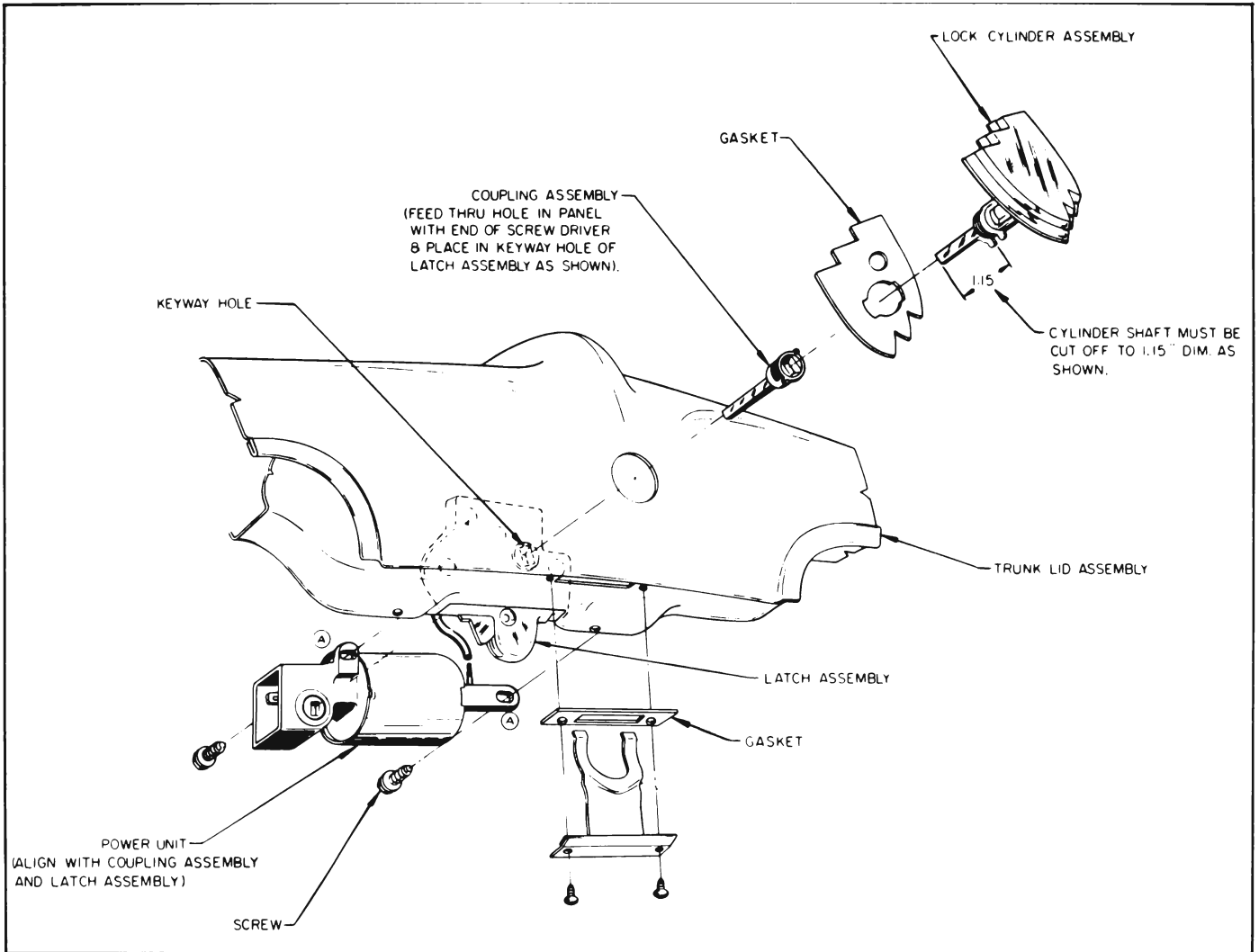

Figure 11-144—Power Unit Installation