

SECTION 7

REAR QUARTER

INDEX

Subject	Page	Subject	Page
Description	7-1	C. Removal and Installation - "E-47" Style . .	7-12
Inner Panel Sealing	7-2	Adjustments - "E-47" Style	7-13
Window Assembly - "A & B-11" and "A-07"		D. Removal and Installation - "F-37 & 67"	
Styles	7-2	Styles	7-16
Window Adjustments - "A & B" Closed Styles . .	7-3	Adjustments - "F-37 & 67" Styles	7-17
Window Assembly - "X-11" Style	7-4	E. Removal and Installation - "X-37" Style . .	7-17
Window Adjustments - "X" Closed Styles	7-4	Adjustments - "X-37" Style	7-18
Window Regulator (Manual and Electric) -		F. Removal and Installation - "Z-37" Style . .	7-19
"A, B & X" Closed Styles	7-5	Adjustments - "Z-37" Style	7-19
Window Rear Glass Run Channel - All		Window Assembly - "B-C 47-57-67-87" Styles . .	7-20
Closed Styles	7-7	Removal and Installation	7-20
Window Front Glass Run Channel - All		Adjustments	7-21
Closed Styles	7-8	Window Regulator (Manual or Electric) -	
Window Guide Assembly - "X-11" Styles	7-8	"B-C 47-57-67-87" Styles	7-22
Window Outer Strip Assembly - All Closed		Window Regulator Assembly (Manual or Electric)	
Styles	7-9	"A, E, F, X & Z" Hardtop and Convertible	
Window Rear Vertical Inner Sealing Strip		Styles	7-24
Assembly - "C-47" Styles	7-9	Window Front Guide - "B-C 47-57-67-87"	
Window Assembly - All Hardtop and Convertible		Styles	7-25
Styles Except "B-C" Series	7-10	Window Front Guide Assembly - "A-X-Z" Hard-	
A. Removal and Installation - "A-17 & 67"		top and Convertible Styles and "E-87" Styles . .	7-25
Styles	7-10	Window Rear Guide Assembly - "A-X-Z" Hardtop	
Adjustments - "A-17 & 67" Styles	7-11	and Convertible Styles and "E-87" Styles	7-26
B. Removal and Installation - "E-87" Style . .	7-12	Window Guide Assembly - All "F" Styles	7-26
Adjustments - "E-87" Style	7-12	Window Glass Run Channel - "E-47" Styles	7-26

DESCRIPTION

On closed style bodies, rear quarter windows operate within glass run channels. On hard-top and convertible styles, nylon rollers, which are components of the lower sash channel or bolt directly to window glass, operate within window front and rear guides.

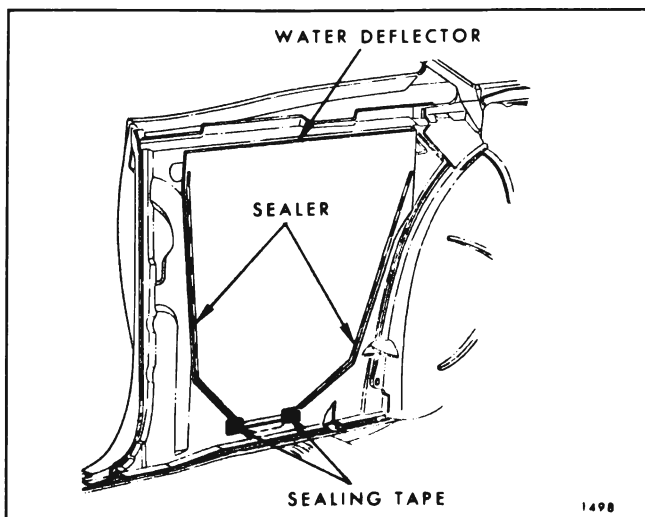

Fig. 7-1—Rear Quarter Inner Panel Sealing - Typical of Water Deflector Installation

All side windows are constructed of solid tempered safety plate glass. Use caution when handling these

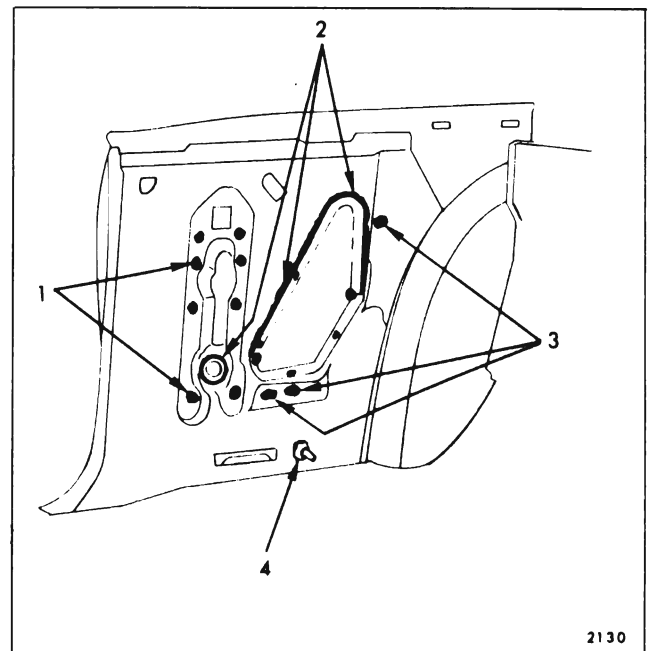

Fig. 7-2—Rear Quarter Inner Panel Sealing - "67" Styles

- | | |
|-----------------------------------|--------------------------------------|
| 1. Regulator Attaching Bolt Slots | 3. Window Guide Adjusting Stud Slots |
| 2. Access Hole Covers | 4. Electrical Harness Grommet |

7-2 REAR QUARTER

assemblies which may shatter if chipped or deeply scratched. **DO NOT** attempt to grind or drill glass.

In order to perform any service operations in the rear quarter, it is necessary to remove the rear quarter trim as specified in the trim section (see index).

REAR QUARTER INNER PANEL SEALING

All rear quarter inner panels are sealed with one or a combination of water deflectors, access hole covers, sealing plugs (or grommets) and body sealer. Service procedures for inner panel water deflectors are outlined in the "Front and Rear Door" section of this manual (see index). Figure 7-1 is typical of a water deflector installation.

Inner panel access hole covers are retained by screws and sealed with a non-hardening body sealer. Usually, removal of either the water deflector or access hole cover will provide the clearance required for service procedures of rear quarter hardware. Whenever any seal has been

disturbed, however, the area must be carefully resealed to prevent waterleaks. Body caulking compound is recommended for service sealing. Figure 7-2 illustrates quarter inner panel sealing on styles which use individual seals at all hardware attaching locations.

Figures 7-3, 7-4, 7-5, 7-6, 7-7, 7-8, 7-9, 7-10, 7-11, 7-12, 7-13, 7-14 and 7-15 illustrate the rear quarter hardware components and their relationship to each other on various styles.

REAR QUARTER WINDOW— "A & B-11" and "A-07" Styles

Removal and Installation

1. Remove rear quarter trim assembly and inner panel water deflector.
2. On "A" styles, remove glass run channel outer strip assembly. Refer to index of "Front and Rear Door" section for strip assembly removal.

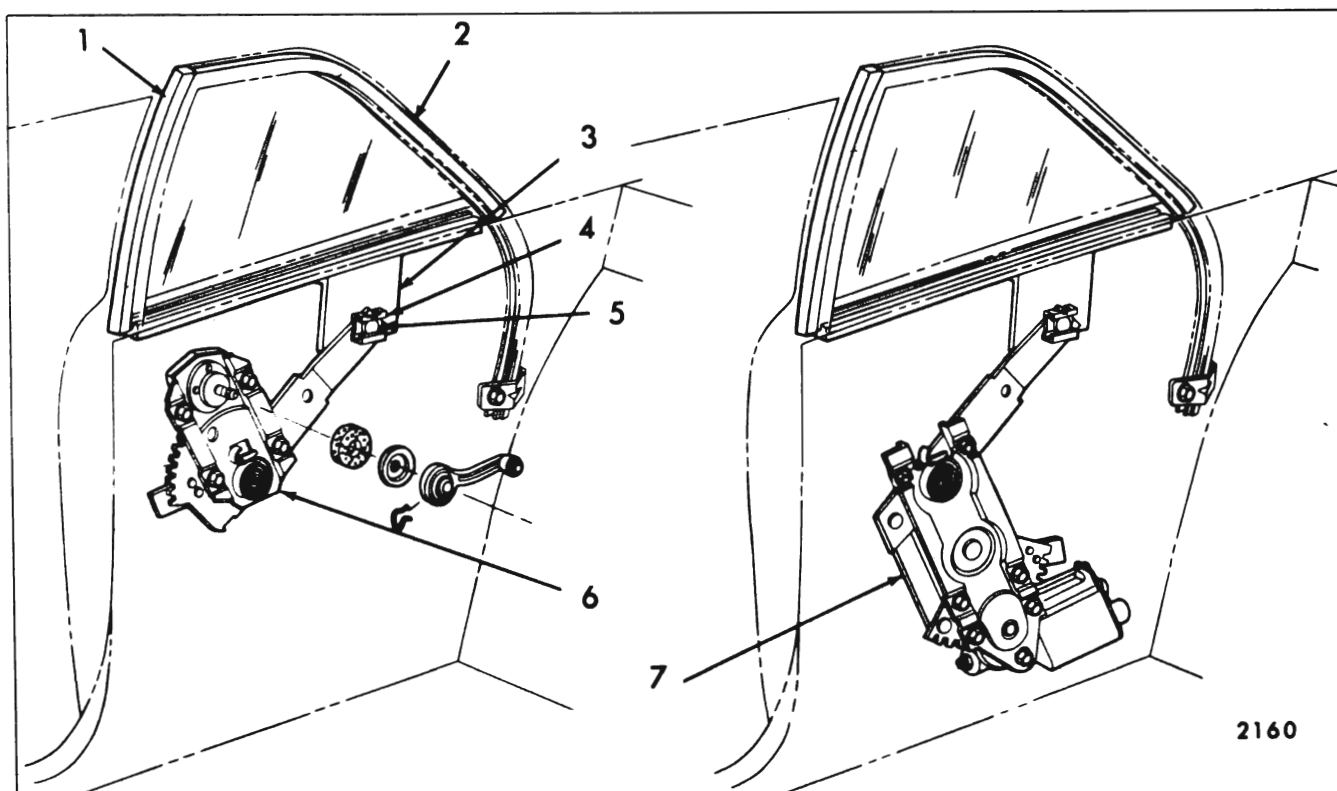

Fig. 7-3—Rear Quarter Hardware - "A & B-11" Styles

1. Front Glass Run Channel
2. Rear Glass Run Channel
3. Window Lower Sash
4. Clip Retainer

5. Pivot Pin
6. Regulator (Manual)
7. Regulator (Electric)

3. Lower window to a position shown in Figure 7-16 for "A-07" styles and Figure 7-17 for "A-11" Styles.
4. Supporting window with one hand, disengage clip retainer securing regulator lift arm to pivot pin on window lower sash channel ("11" styles) or to lower edge of glass ("07" style).
5. Lower front edge of glass until nylon guide at top of window front vertical sash comes out of front glass channel and rear edge of glass comes out of rear run channel. Then, lift glass up (rear edge first) and remove window from body outboard of window opening.
6. To install, reverse removal procedure.

REAR QUARTER WINDOW ADJUSTMENTS—"A & B" Closed Styles

All window assembly adjustments are provided at the window regulator attaching screws.

1. To obtain proper seating of the glass in the upper glass run channels, or proper contact between belt sealing strips and lower sash channel, loosen regulator attaching screws and adjust window as required.
2. To eliminate a fore and aft bind between the glass run channels (hard operating window), or a condition where window will not stay in rear run channel, loosen rear run channel attaching bolt and adjust run channel fore or aft as required.

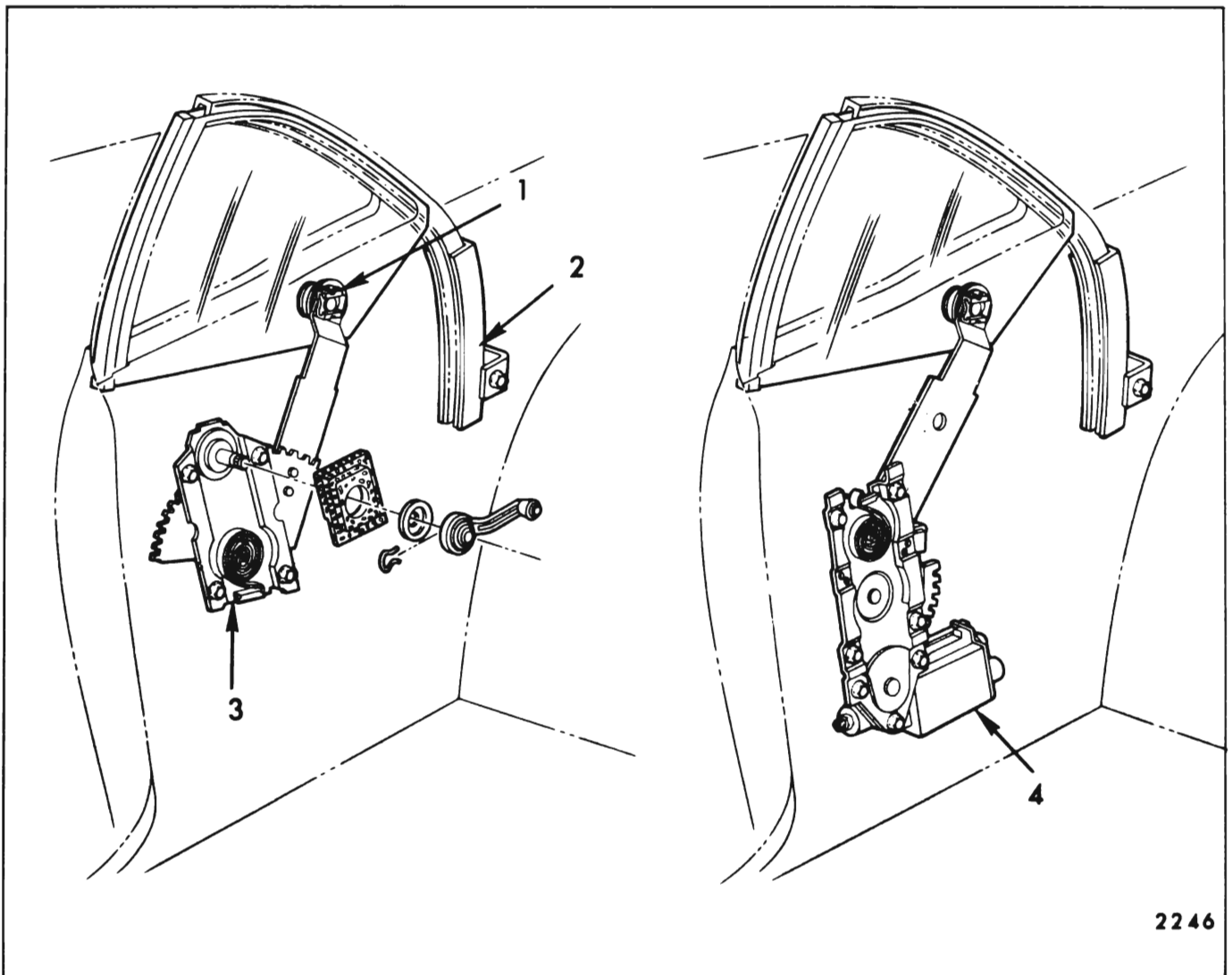

Fig. 7-4—Rear Quarter Hardware - "A-07" Style

1. Glass Retainer
2. Glass Run Channel

3. Window Regulator (Manual)
4. Window Regulator (Electric)

REAR QUARTER WINDOW— "X-11" Style

Removal and Installation

1. Remove rear quarter trim assembly and inner panel water deflector.
2. Remove glass run channel inner and outer strip assemblies (at belt). Refer to index of "Door" section for removal procedure.
3. With window in the full up position, remove window support to regulator plate attaching screws (Fig. 7-18).
4. Operate window regulator down. Disengage window assembly from regulator arm and tilt rear of window downward to disengage window from glass run channels. Lift window upward and inboard and remove from body.

5. To install, reverse removal procedure.

REAR QUARTER WINDOW ADJUSTMENTS—"X" Closed Styles

For proper operation of rear quarter window and correct seating of glass in run channels, adjust rear quarter window in the following sequence:

1. With the window in the full "up" position, loosen the window support to regulator plate attaching screws and the center guide attaching screws.
2. Using hand pressure, press window upward and forward to make certain it is "bottomed" in the upper and forward glass run channels.
3. Tighten window support to regulator plate attaching screws and center guide upper attaching screw.

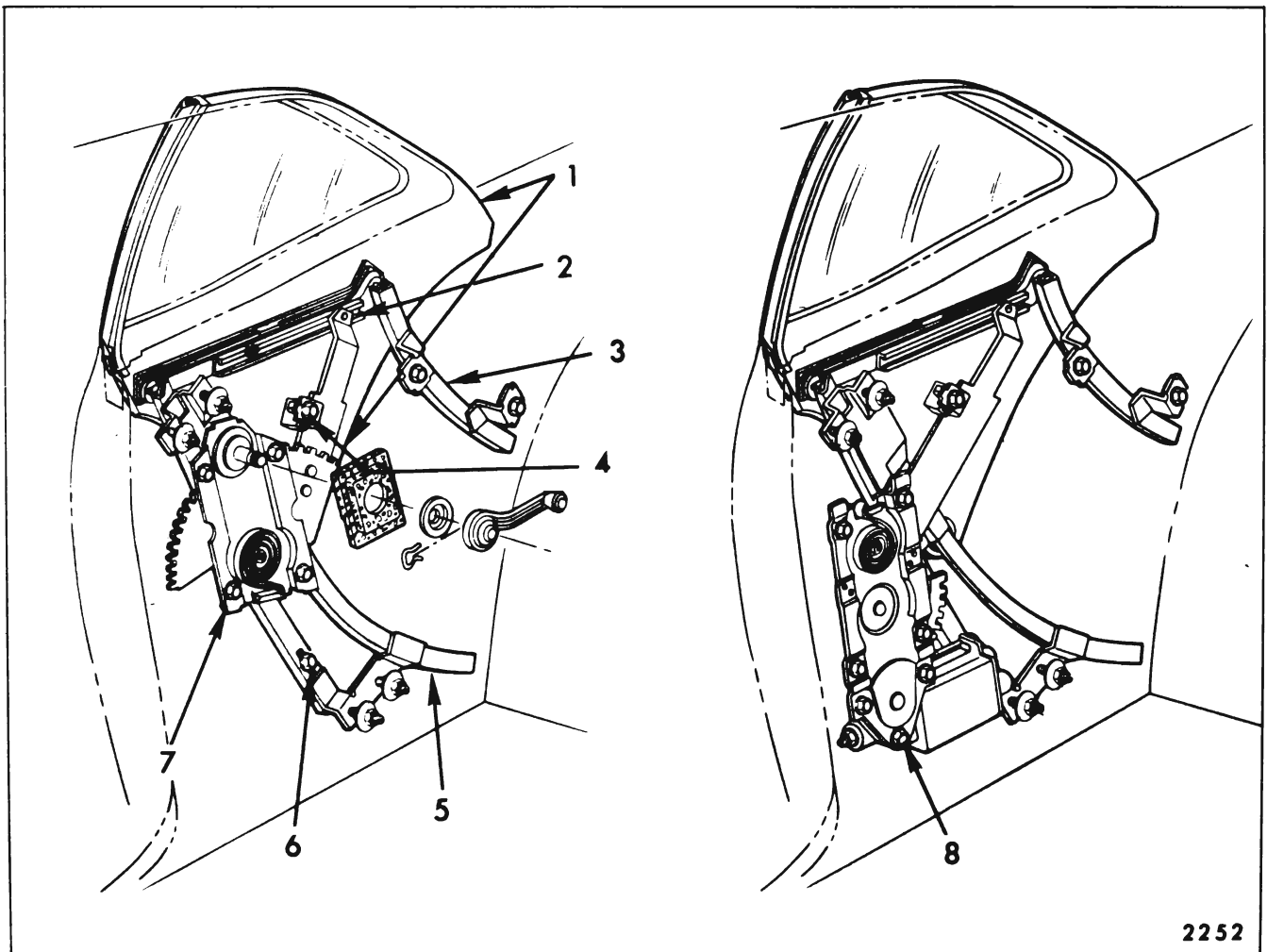

Fig. 7-5—Rear Quarter Hardware - "A-17" Style

1. Window Glass
2. Sash Channel Cam
3. Rear Guide

4. Up-Stop
5. Front Guide
6. Down-Stop

7. Window Regulator (Manual)
8. Window Regulator (Electric)

4. Lower window to full "down" position. Tighten center guide lower attaching screw while forcing lower portion of guide rearward.

NOTE: Do not apply too much pressure when forcing guide rearward as this tends to make front edge of glass dig into front run channel.

REAR QUARTER WINDOW REGULATOR (MANUAL AND ELECTRIC)— "A, B & X" Closed Styles

Removal and Installation

1. Remove rear quarter trim assembly and inner panel water deflector. On electric styles, disconnect feed wire from regulator motor.
2. On "A & B" styles, disengage clip retainer from pivot pin on window lower sash channel (see Fig. 7-16 and 7-17). Raise window to full-up and prop in that position.

3. On "X" styles, remove support to regulator plate screws (Fig. 7-18). Raise window to full-up and prop in that position.
4. On "A & B" styles, remove regulator to inner panel screws and remove regulator through large access hole (see Fig. 7-19).
5. On "X" styles, remove regulator to inner panel screws (Fig. 7-18). Disengage roller on regulator plate from window guide and remove regulator through large access hole.
6. To install, reverse removal procedure.

NOTE: The procedure for removing electric motor from regulator is described under "Door and Quarter Window Regulator Electric Motor Assembly" in the Door section of this manual.

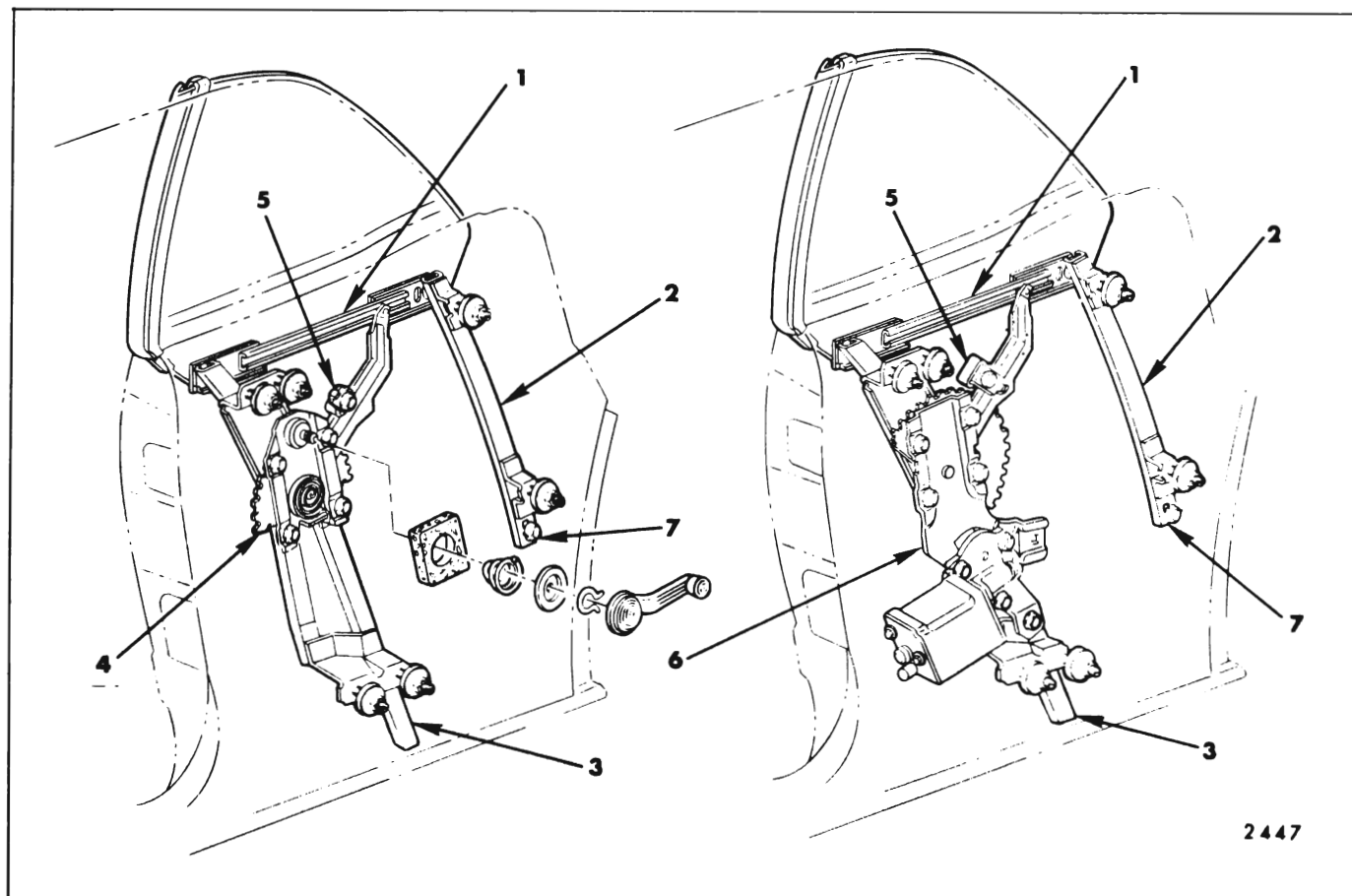
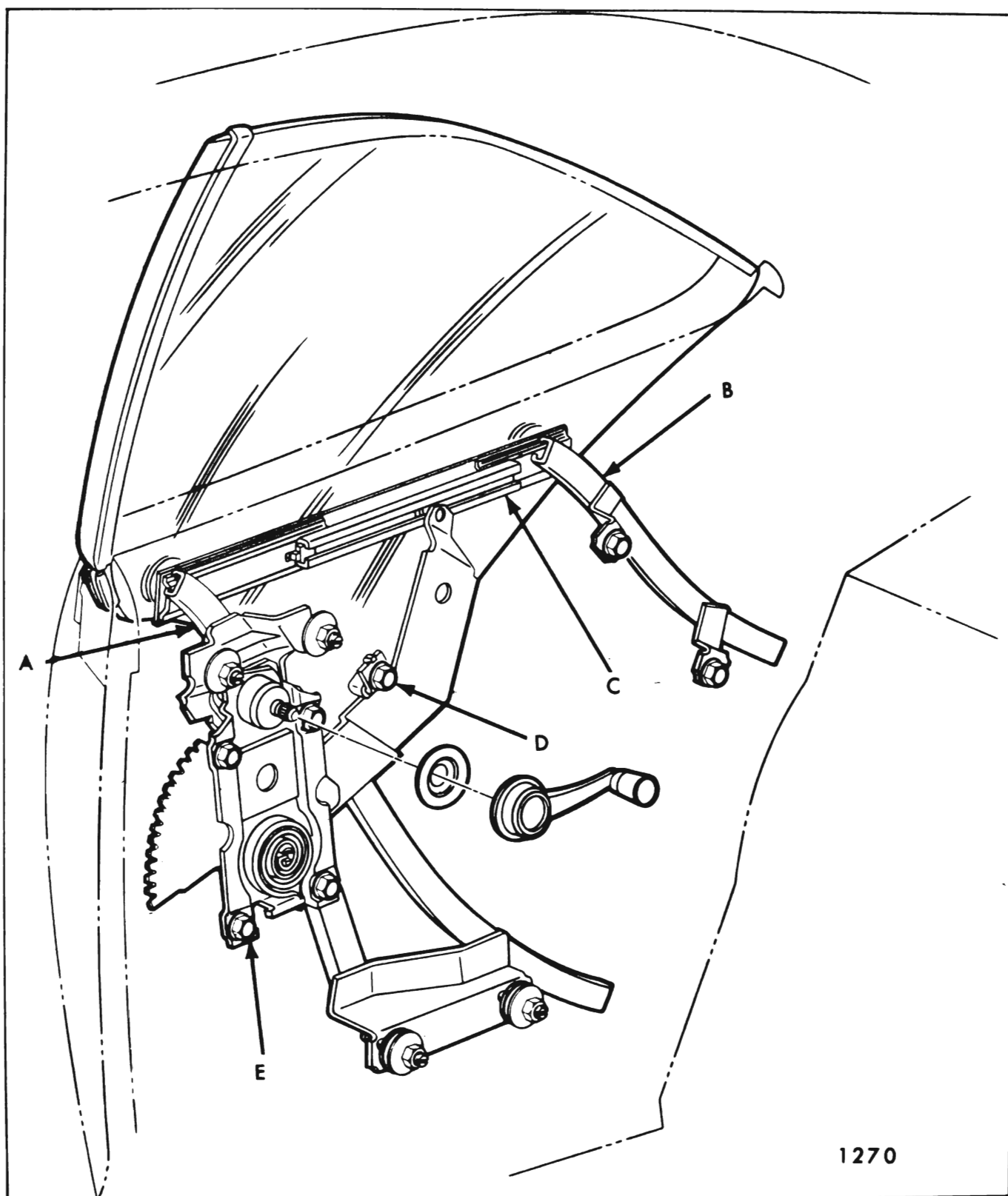

Fig. 7-6—Rear Quarter Hardware - "A-67" Styles

1. Sash Channel Cam
2. Rear Guide
3. Front Guide
4. Window Regulator (Manual)

5. Up-Stop
6. Window Regulator (Electric)
7. Rear Guide Lower Stop



1270

Fig. 7-7—Rear Quarter Hardware - "B-87" Styles

- A. Front Guide
- B. Rear Guide
- C. Lower Sash Channel Cam

- D. Window Up-Stop
- E. Window Regulator

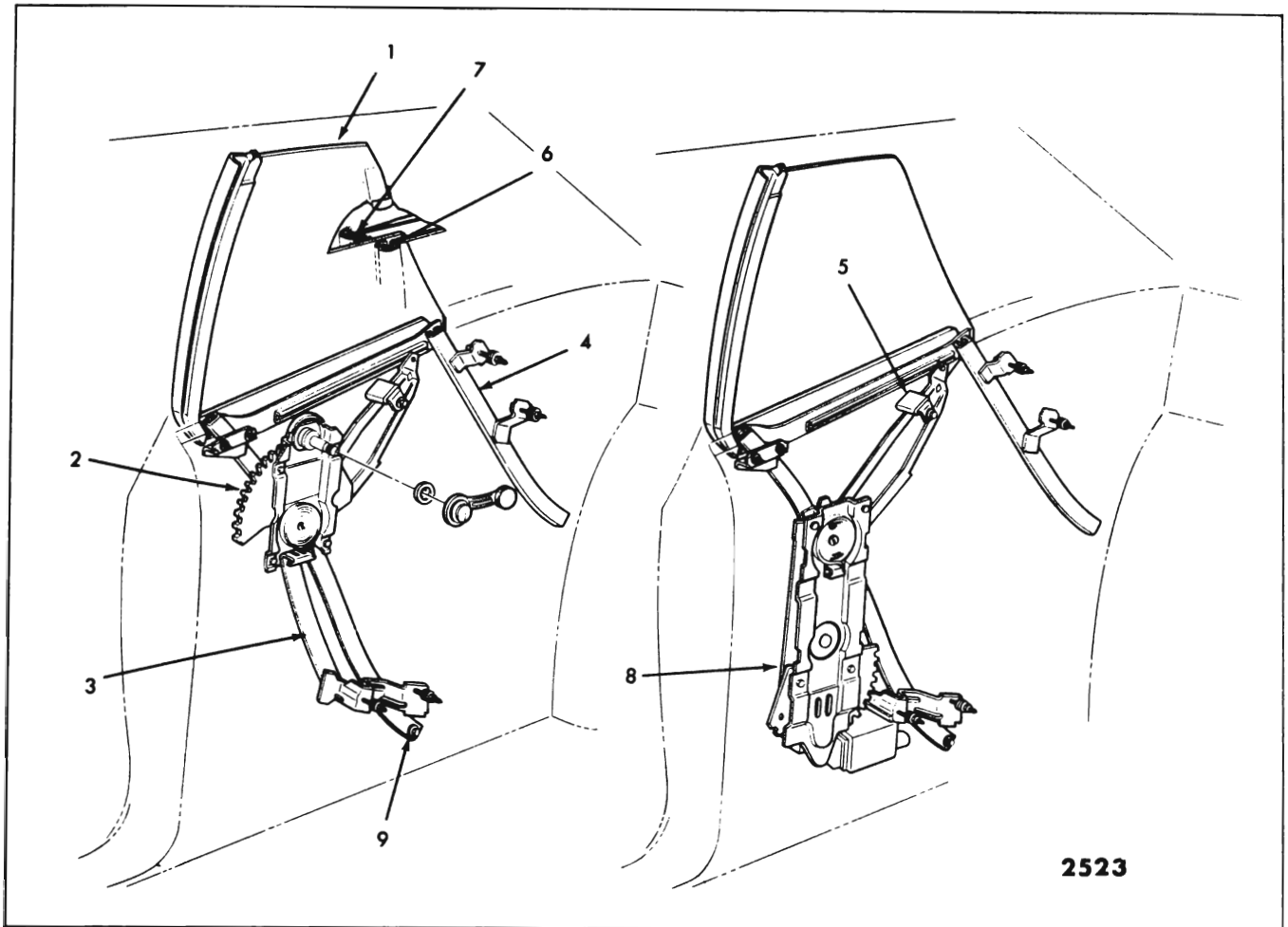

Fig. 7-8—Rear Quarter Hardware - "C-47" Styles Shown, "B-C 57-67" Styles Similar

- 1. Quarter Window Assembly
- 2. Window Regulator (Manual)
- 3. Front Guide

- 4. Rear Guide
- 5. Window Upper Stop
- 6. Section Through Vertical Inner Sealing Strip

- 7. Section Through Roof Rear Drip Molding (With Integral Outer Sealing Strip)
- 8. Window Regulator (Electric)
- 9. Window Lower Stop

REAR QUARTER WINDOW REAR GLASS RUN CHANNEL—All Closed Styles

Removal and Installation

1. Remove rear quarter window as previously described.
2. Remove run channel to inner panel attaching bolt (Fig. 7-20).
3. On "A-07" style, remove screws securing run channel to side roof rail along length of run channel.
4. Using a flat-bladed tool, carefully pry run

channel retaining clips from piercings in side roof rail.

NOTE: If difficulty is encountered disengaging run channel, inspect inside of channel for the presence of screws.

5. At belt line on "A" styles, disengage tab on rear run channel from side roof rail by moving run channel downward into opening between the panels; then, remove run channel from body.
6. Prior to installation, inspect foam sealing material for any damage that would result in waterleaks, and replace as necessary.
7. To install, reverse removal procedure.

REAR QUARTER WINDOW FRONT GLASS RUN CHANNEL—All Closed Styles

Removal and Installation

1. Remove rear quarter window as previously described.
2. On "A" styles, remove screws along length of run channel securing channel to body (Fig. 7-20).
3. On all styles, using a flat bladed tool, pry run channel from body pillar and remove run channel (Fig. 7-21).
4. To install, reverse removal procedure. Prior to installation inspect sealing material on body

pillar or run channel and replace or add to as required.

REAR QUARTER WINDOW GUIDE ASSEMBLY—"X-11" Styles

Removal and Installation

1. Remove rear quarter trim assembly and trim finishing upper molding.
2. Detach inner panel water deflector sufficiently to gain access to guide attaching screws.
3. Remove guide attaching screws, disengage guide from roller on regulator arm and remove guide through access hole (See Fig. 7-22).
4. To install, reverse removal procedure.

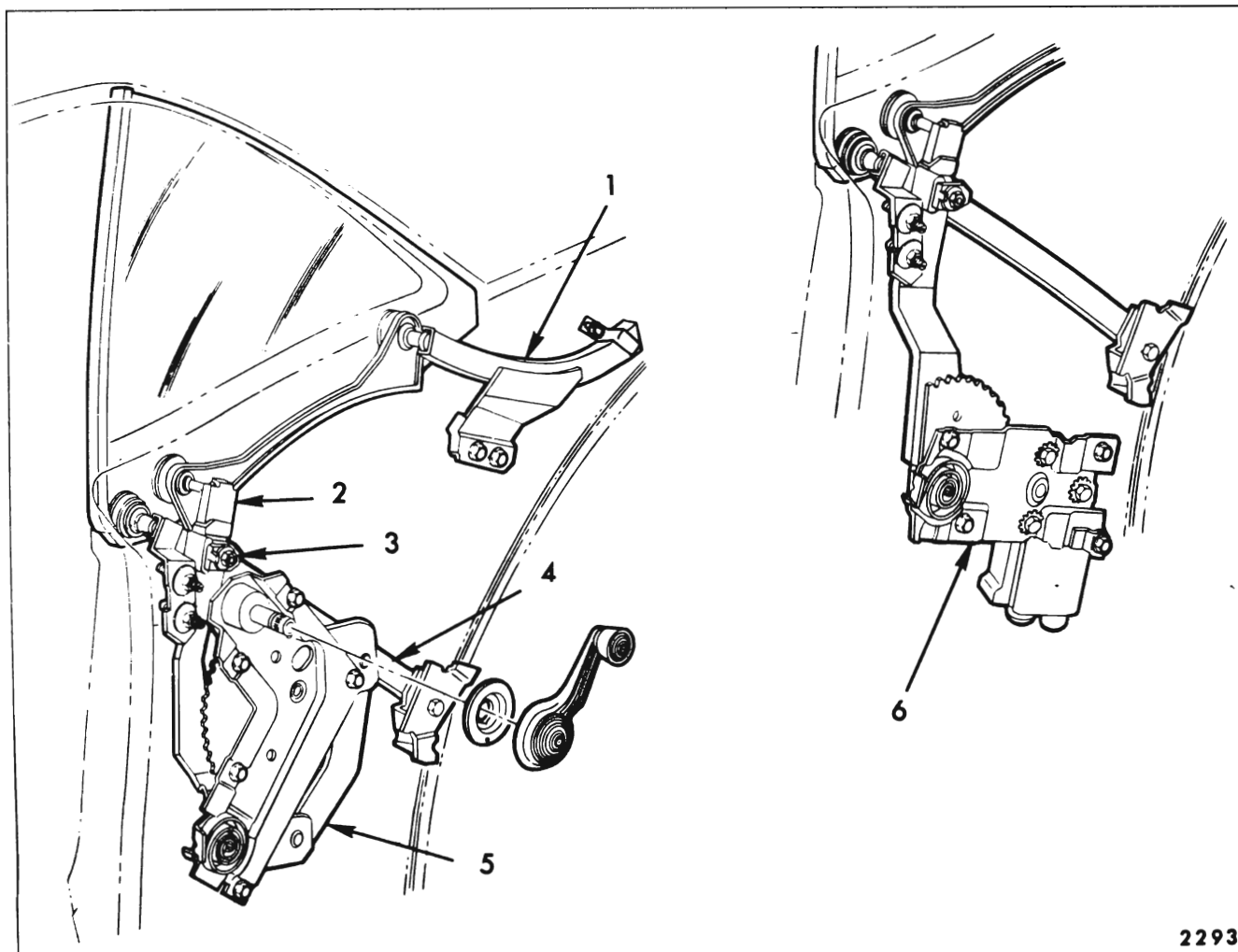

Fig. 7-9—Rear Quarter Hardware - Buick "E" Styles

1. Rear Guide
2. Regulator Lift Arm Cam
3. Up-Stop

4. Front Guide
5. Regulator (Manual)
6. Regulator (Electric)

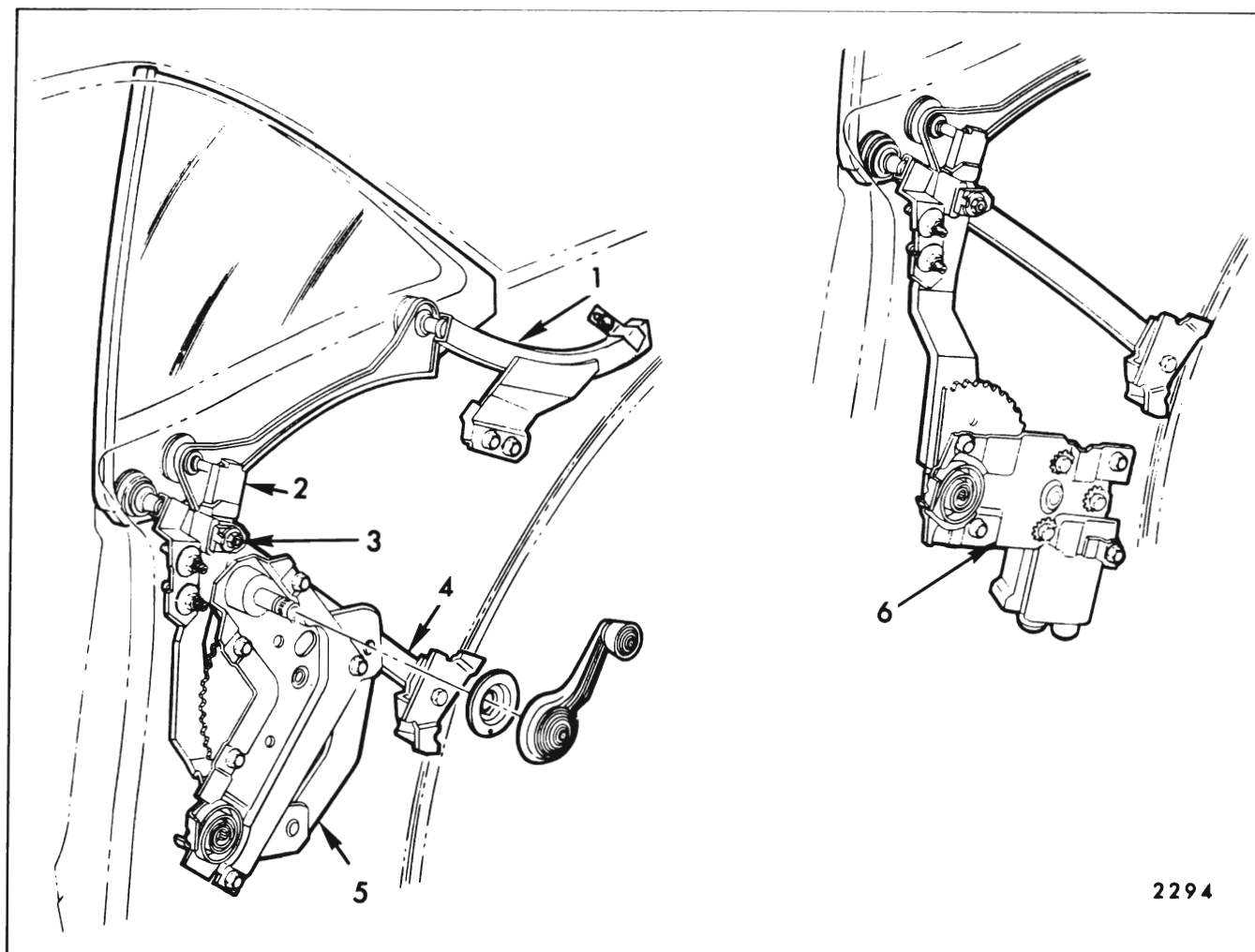

Fig. 7-10—Rear Quarter Hardware - Oldsmobile "E" Body

1. Rear Guide
2. Regulator Lift Arm Cam
3. Up-Stop

4. Front Guide
5. Regulator (Manual)
6. Regulator (Electric)

REAR QUARTER WINDOW OUTER STRIP ASSEMBLY—All Closed Styles

1. Remove rear quarter trim assembly and inner panel water deflector.
2. On "A & B" styles, disengage window assembly from regulator lift arm by removing slotted retainer (see Fig. 7-17). On "X" styles remove support to regulator plate screws (Fig. 7-18).
3. Lower window assembly to bottom of rear quarter and rest it against outer panel.
4. On styles with screw retained strip assemblies, remove screws securing outer strip to rear quarter outer panel return flange and

remove strip from body (see Fig. 7-23). On styles with clip retained strip assemblies, refer to index of "Door" section for removal procedure.

NOTE: Use care not to damage strip assembly or adjacent painted surfaces.

5. To install, reverse removal procedure.

REAR QUARTER WINDOW REAR VERTICAL INNER SEALING STRIP ASSEMBLY—"C-47" Styles

The rear vertical inner sealing strip assembly serves as a glass run channel above the belt for the rear quarter window. As shown in Figure 7-24

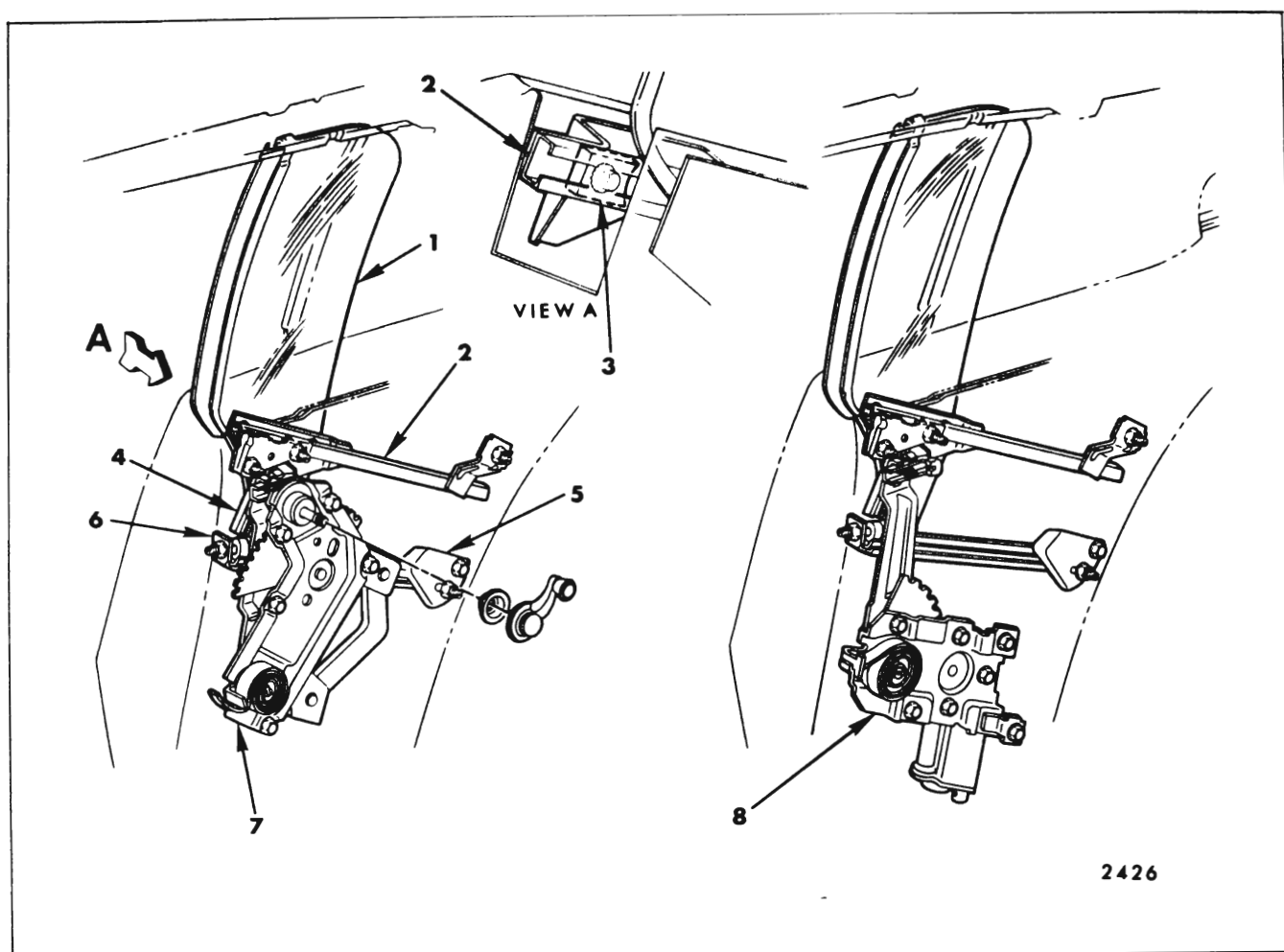

Fig. 7-11—Rear Quarter Hardware - Cadillac "E" Body

1. Rear Quarter Window
2. Sash Channel Cam
3. Sash Channel Cam Stop

4. Vertical Cam
5. Glass Run Channel
6. Glass Run Channel Strip

7. Regulator (Manual)
8. Regulator (Electric)

the strip assembly is retained by clips which snap over the leading edge of the quarter inner upper panel.

To remove the strip assembly, it is necessary to remove the rear quarter trim assembly and the side roof rail rear finishing molding which covers the sealing strip clips.

REAR QUARTER WINDOW ASSEMBLY— All Hardtop and Convertible Styles Except "B-C" Series

The rear quarter window is made of solid tempered safety plate glass. Consequently, it cannot be drilled or ground, or develop scratches or edge chips as it will shatter. The window assembly consists of a pressed-on front vertical sash channel and a bolt-on lower sash channel assembly.

NOTE: When reinstalling glass to sash channel bolts, or nylon roller nuts, torque to 72 inch pounds (6 foot pounds). Also, replace glass to sash channel spacers (rubber).

Refer to front of this section for hardware drawings which can assist in performing any of the following procedures. To perform any of these service operations, remove rear quarter trim assembly and inner panel water deflector or access hole cover.

A. REMOVAL AND INSTALLATION— "A-17 & 67" Styles

1. Lower folding top on "67" styles.
2. Remove rear guide upper and lower attaching screws (Fig. 7-25 and 7-26). Disengage guide from sash channel roller and remove guide.

3. Remove glass run channel outer strip assembly (draft strip - see "Door" index of manual).
4. Remove the lower two adjusting stud nuts of the quarter window front guide and all but the top attaching bolt of window regulator (see Fig. 7-27).
5. Rotate regulator counter-clockwise until lift arm roller is free of quarter window sash channel cam. Rotate rear edge of glass upward (outboard of side rail on "17" styles) and remove window (see Fig. 7-27).

NOTE: If additional clearance is needed on "17" styles, the side roof rail weatherstrip can be detached at quarter window area.

6. To install, reverse removal procedure.

ADJUSTMENTS—"A-17 & 67" Styles

To perform any rear quarter window adjustments, it is necessary to remove the rear quarter trim assembly.

1. To adjust window "fore or aft", loosen front

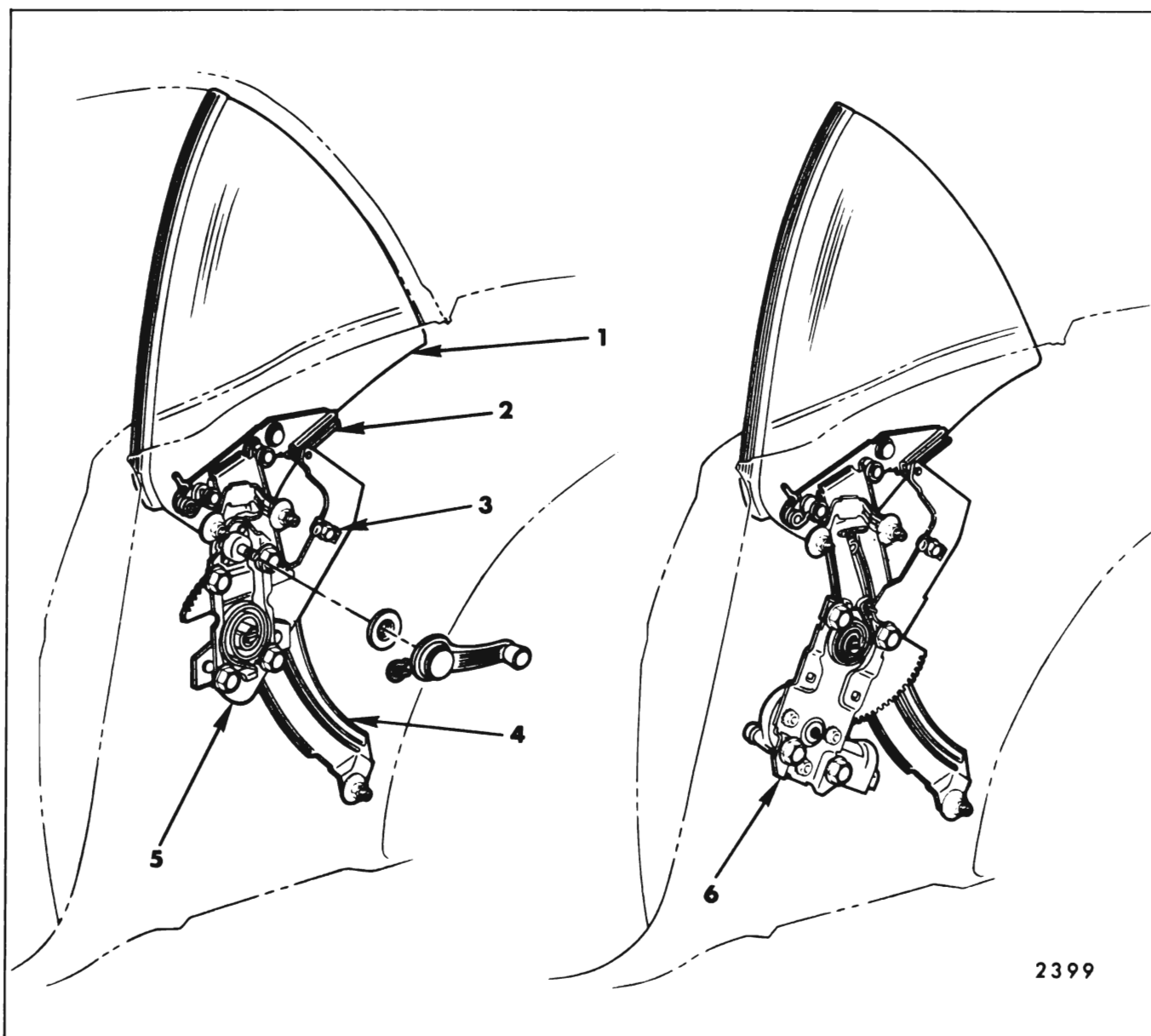

Fig. 7-12—Rear Quarter Hardware - "F" Body Styles

1. Rear Quarter Window
2. Sash Channel Cam
3. Up-Stop

4. Window Guide
5. Regulator (Manual)
6. Regulator (Electric)

7-12 REAR QUARTER

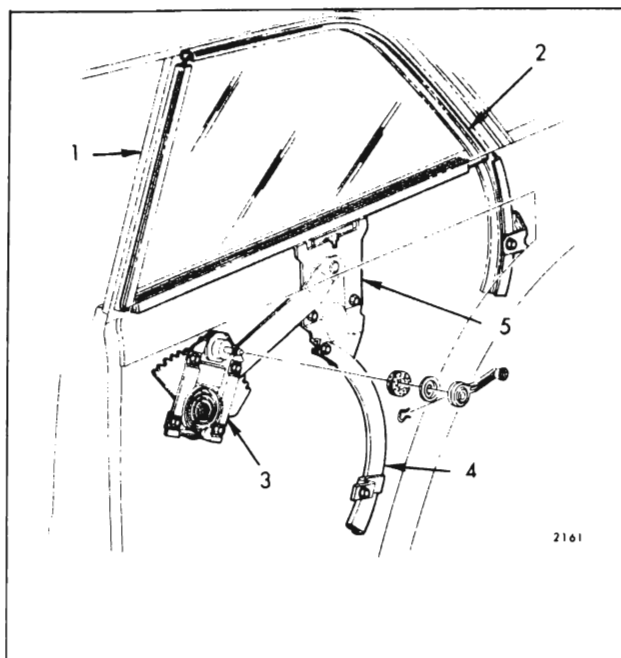

Fig. 7-13—Rear Quarter Hardware - "X-11" Style

- | | |
|----------------------------|----------------------|
| 1. Front Glass Run Channel | 4. Window Guide |
| 2. Rear Glass Run Channel | 5. Window Support to |
| 3. Window Regulator | Regulator Plate |

and rear guide adjusting stud nuts, position window and guides as required, and tighten nuts.

2. To adjust window "in or out" at belt line, loosen front guide upper adjusting stud nuts, adjust studs in or out as required, and tighten stud nuts.
3. To adjust top of window "in or out", loosen front guide lower adjusting stud nuts, adjust studs in or out as required, and tighten stud nuts.
4. To relieve a "fore or aft" binding condition between front and rear guides, loosen rear guide adjusting stud nut. Operate window to "full-down" position and tighten remaining stud nut.
5. To limit up-travel of window, adjust window stop as required (see Fig. 7-25 and 7-26).

B. REMOVAL AND INSTALLATION— "E-87" Styles

1. With window in a full-up position, remove rear guide upper and lower attaching bolts. Disengage guide from roller on window assembly and remove guide through access hole (see Fig. 7-28).

2. With quarter window partially lowered, remove nuts securing regulator lift arm cam to regulator lift arm and remove cam.

NOTE: Lift arm must be pushed inboard slightly to remove cam.

3. While supporting glass, remove quarter window front guide attaching bolts and lower guide to bottom of rear quarter.
4. Remove quarter window inboard of roof panel.
5. To install, reverse removal procedure. Fig. 7-29 is an exploded view of the quarter window assembly and identifies the various components and their assembly sequence.

ADJUSTMENTS—"E-87" Styles

Fore and aft alignment is determined by positioning front guide. Adjusting rear guide will provide parallel condition of quarter window to door for constant seal. In or out alignment is determined by upper two adjusting studs and nuts at front guide. The adjustable up-stop will provide up or down alignment and partially fore and aft alignments by controlling window travel.

NOTE: Adjustments on regulator lift arm cam are provided to permit maximum travel but caution must be observed so not to interfere with quarter trim assembly at belt.

C. REMOVAL AND INSTALLATION— "E-47" Styles

1. Remove rear quarter window lower garnish molding.
2. Remove inner panel cam adjusting stud nuts and turn studs inboard sufficiently to clear rear quarter inner panel (See Fig. 7-30).
3. Remove lock pillar sealing strip (rubber flap at belt line).
4. With quarter window fully forward, disengage inner panel cam from window rollers by sliding cam rearward. Remove cam from body.
5. Remove nut securing regulator lift arm to window vertical sash channel glass roller (see Fig. 7-30). Disengage lift arm from roller stud. Remove stud from top of vertical sash channel cam (see Fig. 7-31).
6. Pull glass forward and remove inboard of side roof rail.

7. To install, reverse removal procedure.

2. The forward glass stop can be adjusted fore and aft by loosening lock nut and turning stud in or out (see Fig. 7-32).

ADJUSTMENTS—"E-47" Styles

Critical rear quarter window adjustments can be achieved at the lock pillar and **DO NOT** require seat and side wall trim removal (see Fig. 7-32).

NOTE: Stop bolt also retains forward attachment of glass run channel.

1. Remove lock pillar grille.

3. A slight amount of in or out adjustment of glass is provided by an elongated slot at glass run channel forward attachment (see Figure 7-32).

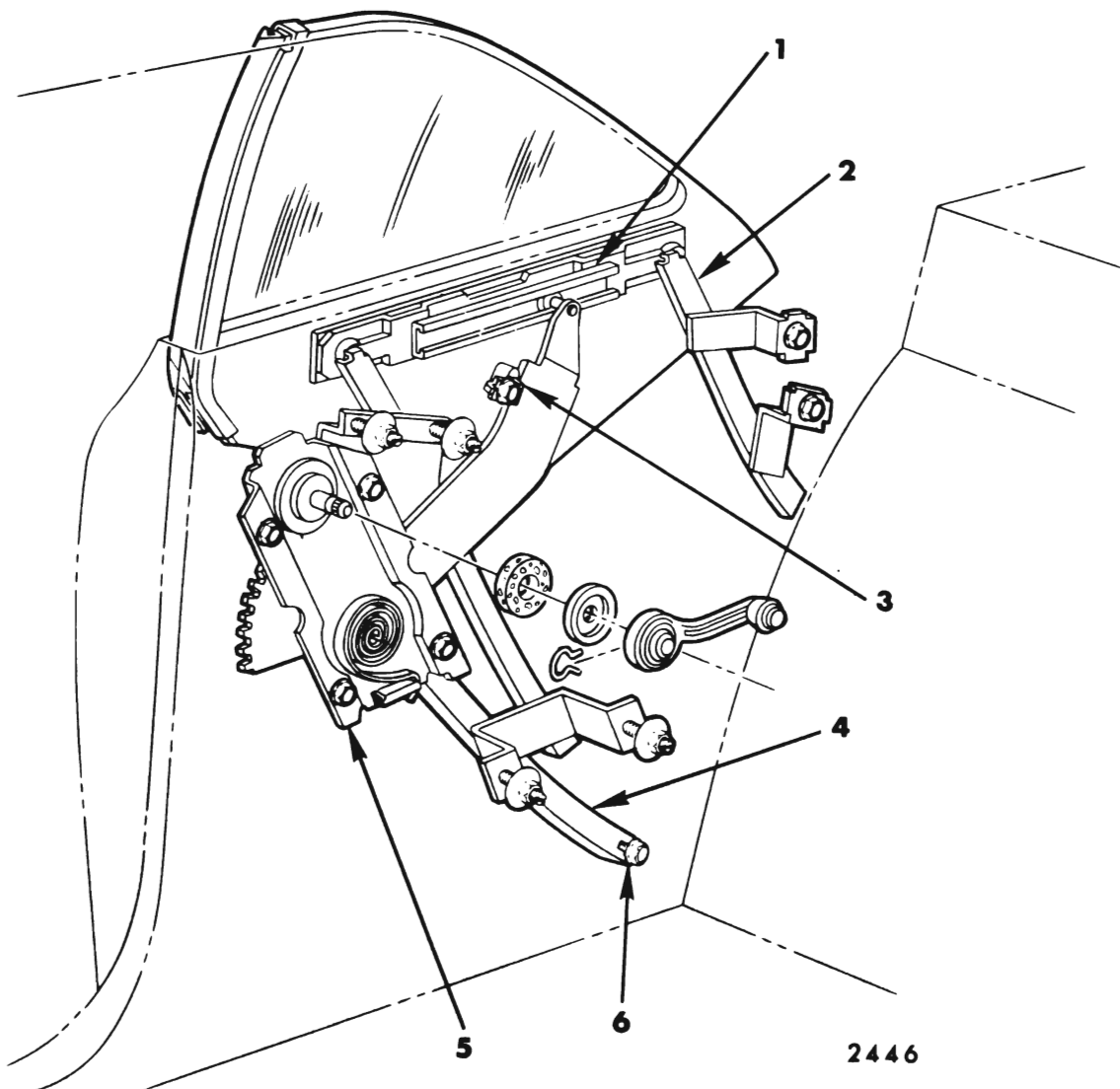

Fig. 7-14—Rear Quarter Hardware - "X-37" Style

1. Sash Channel Cam
2. Rear Guide
3. Upper Stop

4. Front Guide
5. Window Regulator
6. Front Guide Stop

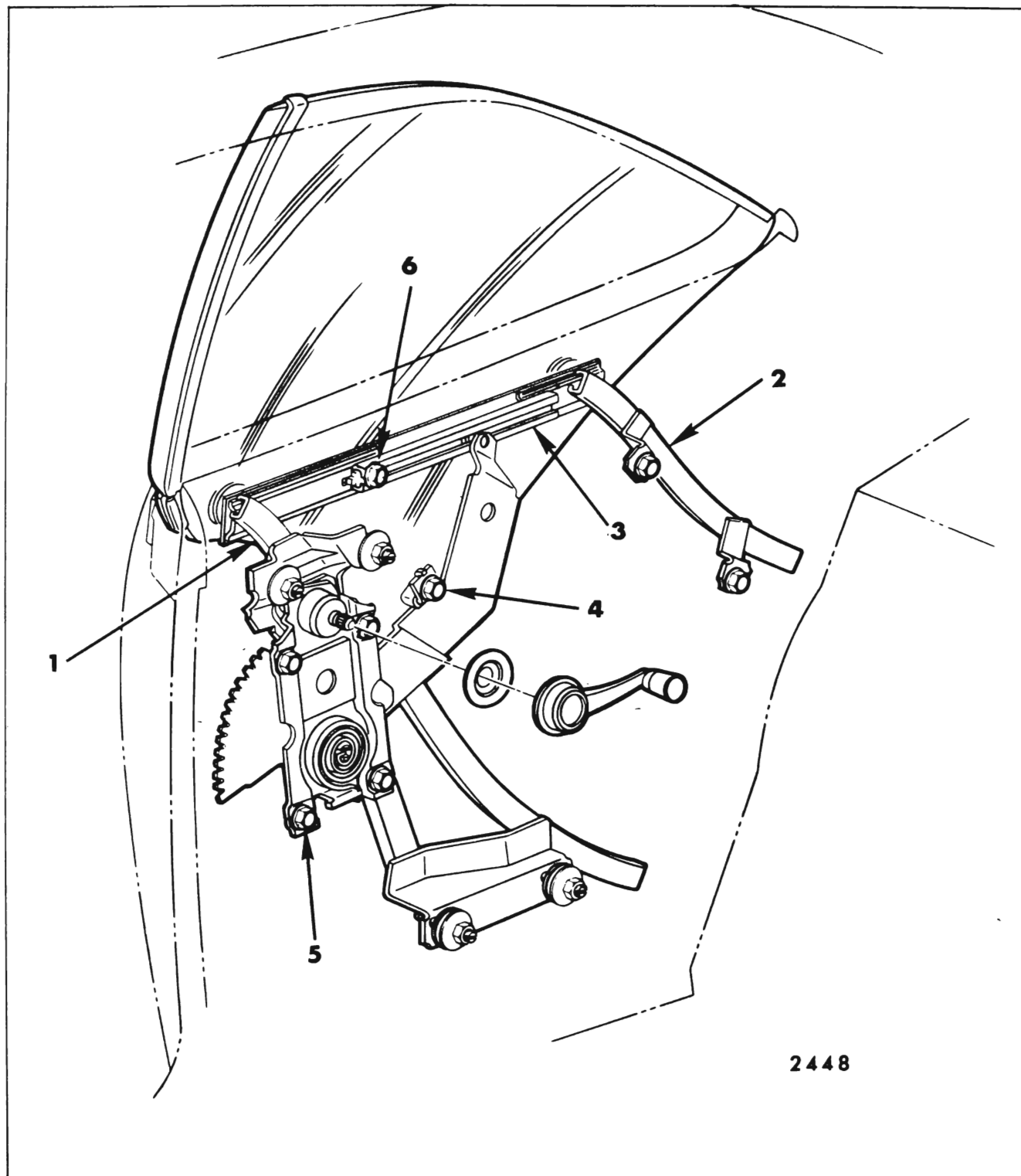

Fig. 7-15—Rear Quarter Hardware - "37" Styles

- 1. Front Guide
- 2. Rear Guide
- 3. Lower Sash Channel Cam

- 4. Window Up-Stop
- 5. Window Regulator
- 6. Window Down-Stop

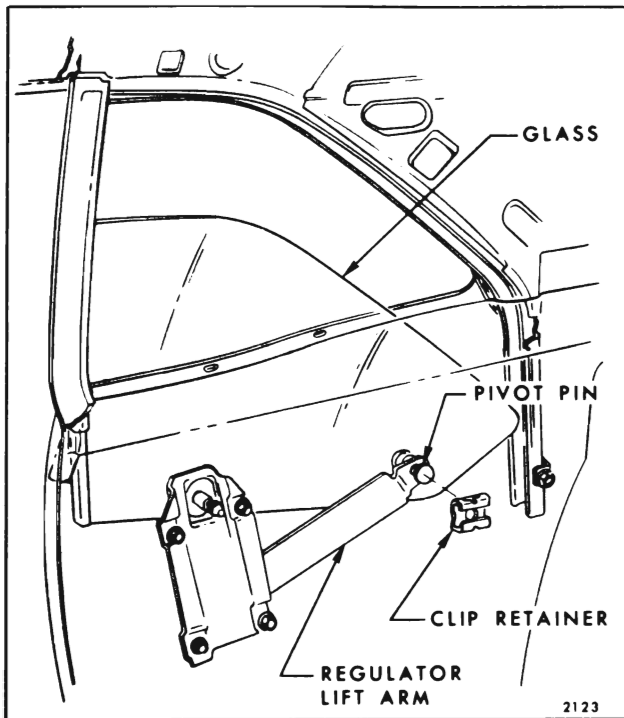

Fig. 7-16—Rear Quarter Window Attachment -
"A-07" Styles

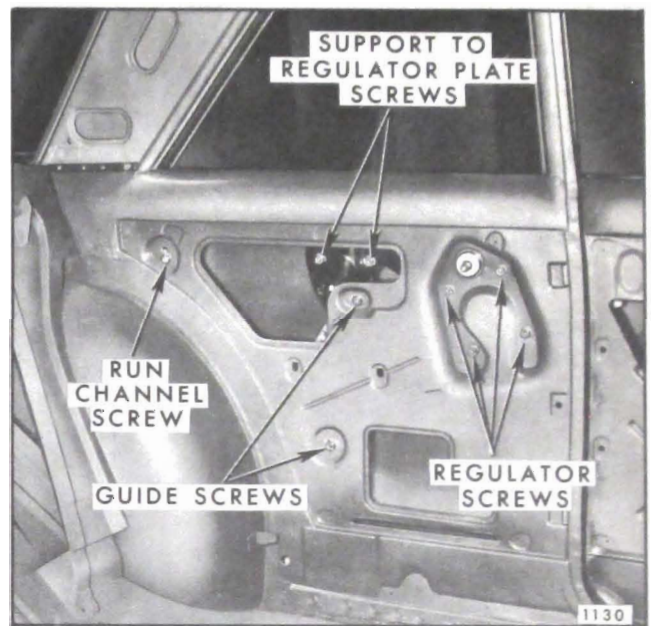

Fig. 7-18—Rear Quarter Hardware Attachment -
"X-11" Style

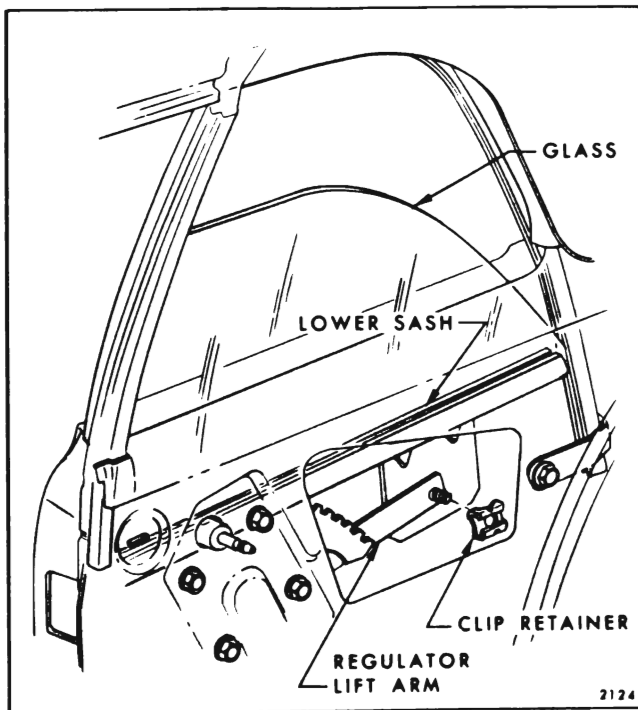

Fig. 7-17—Rear Quarter Window Attachment -
"A and B-11" Styles

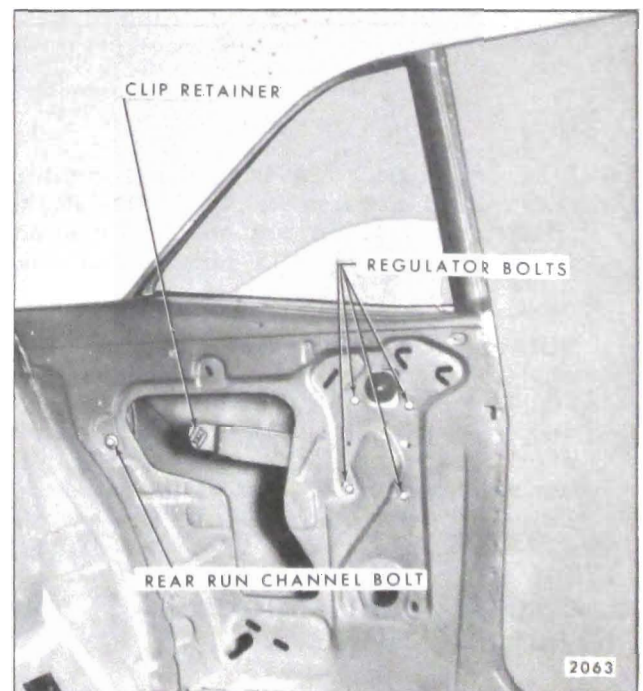

Fig. 7-19—Rear Quarter Hardware Attachment -
"A-07" Styles Shown, "11" Styles Similar

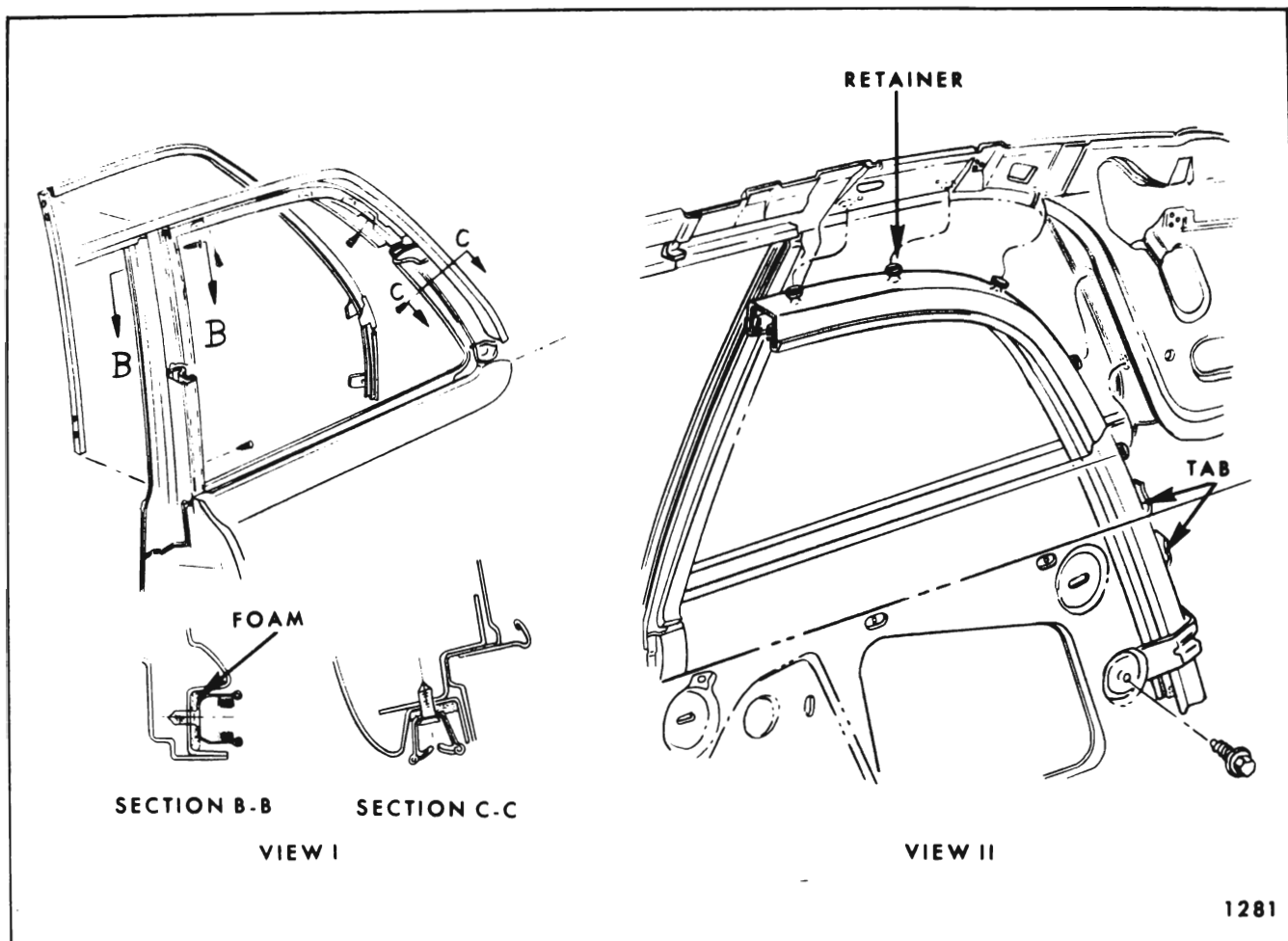

Fig. 7-20—Rear Quarter Window Glass Run Channels - Typical of all Closed Styles

4. A secondary glass stop is located in vertical sash channel cam (see Fig. 7-11). This stop is retained by a single bolt and is accessible through lock pillar grille opening (see Fig. 7-32).

NOTE: Major glass adjustment is available at inner panel cam adjusting studs and nuts (see Fig. 7-30). In addition, the glass run channel rear attachment provides in or out and up or down adjustment. Also, a glass lower stop is attached to the rear plate of the glass run channel. This stop is adjustable fore and aft.

D. REMOVAL AND INSTALLATION— "F-37 & 67" Styles

1. Remove rear quarter window regulator assembly (see index).
2. On convertible styles, lower folding top.

3. Remove upper two nuts of front guide adjusting studs (see Fig. 7-33).

4. Remove lock pillar sealing strip and glass run channel outer strip assembly (belt seal). Removal and installation of lock pillar sealing strips is covered in the "Door" section of this manual (see index). The outer belt seal is retained by screws.

5. On "67" styles, pull window straight up and remove from body. On "37" styles, remove glass outboard of roof panel.

6. To install, reverse removal procedure.

NOTE: Figure 7-34 illustrates relationship of window assembly to guide. Figure 7-35 illustrates all components of the rear quarter window assembly.

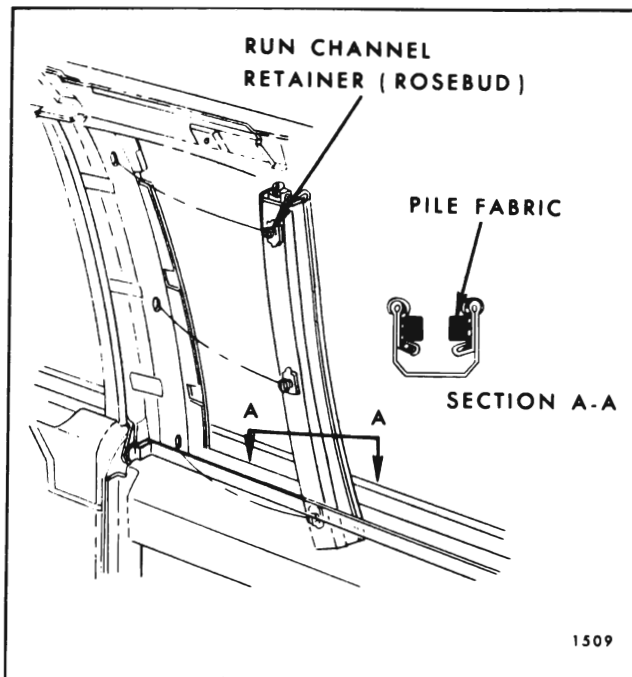

Fig. 7-21—Rear Quarter Window Front Glass Run Channels

ADJUSTMENTS—"F-37 & 67" Styles

In or out and fore or aft adjustment is provided by inner panel slots and adjusting studs of window

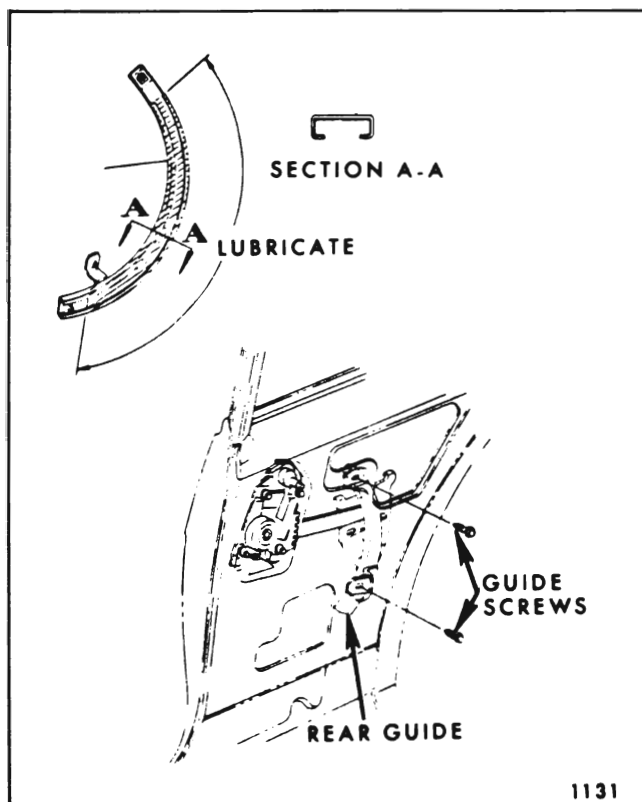

Fig. 7-22—Rear Quarter Window Guide - "X-11" Styles

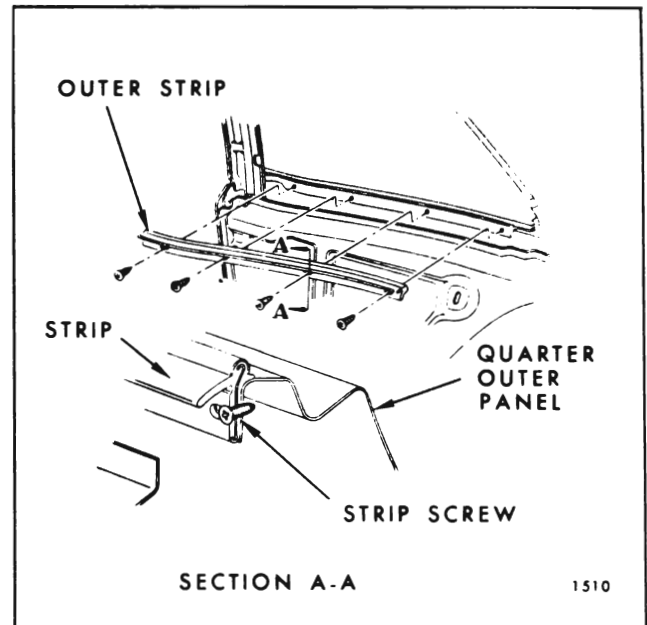

Fig. 7-23—Rear Quarter Window Outer Strip Assembly - All Closed Styles

guide. Up or down travel of glass is controlled by stop located on regulator lift arm (see Fig. 7-33).

E. REMOVAL AND INSTALLATION—"X-37" Styles

1. With window in full-up position, remove rear

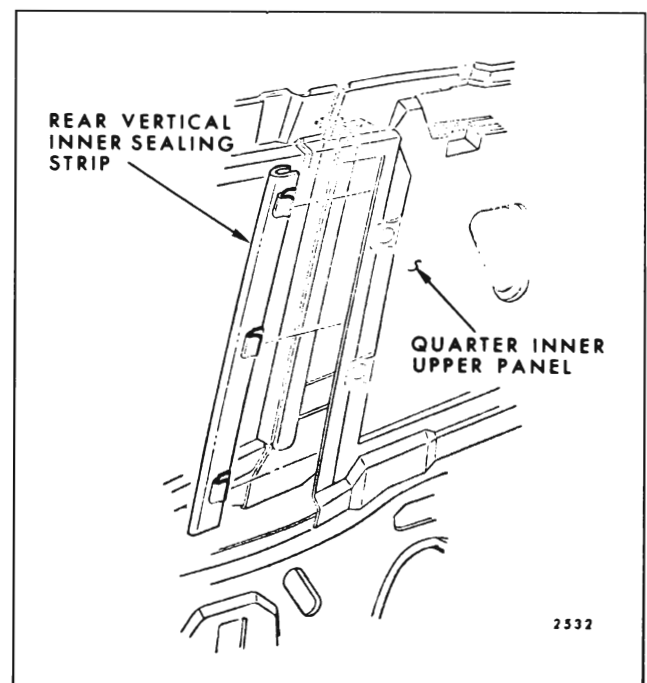

Fig. 7-24—Rear Quarter Window Rear Vertical Inner Sealing Strip Assembly - "C-47" Styles

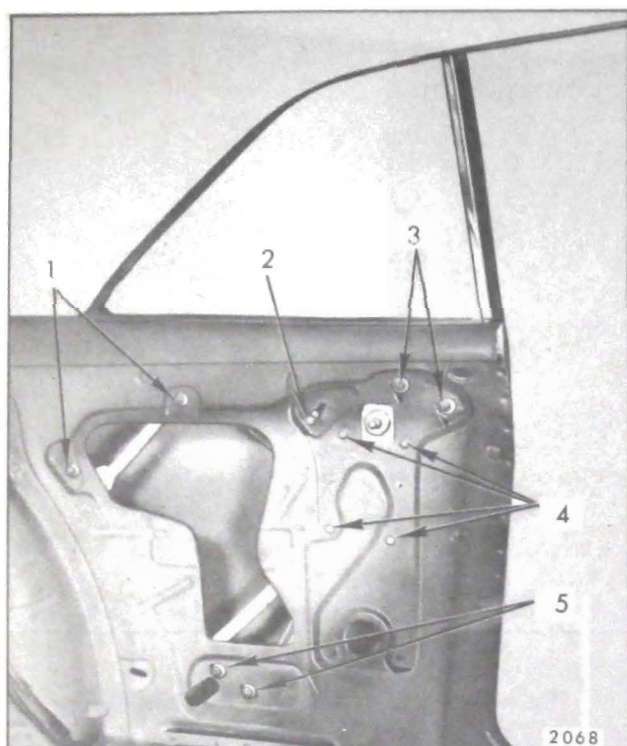

Fig. 7-25—Rear Quarter Hardware - "A-17" Style

- | | |
|-----------------------------------------------|-----------------------------------------------|
| 1. Rear Guide Adjusting Studs and Nuts | 4. Regulator Bolts |
| 2. Up-Stop Bolts | 5. Front Guide Lower Adjusting Studs and Nuts |
| 3. Front Guide Upper Adjusting Studs and Nuts | |

guide upper and lower attaching bolts (Fig. 7-36). Disengage guide from roller on window assembly and remove guide through access hole.

2. Remove glass run channel inner and outer strip assemblies (draft strips) as outlined in the "Front and Rear Door" section of this manual - see index. Remove lock pillar sealing strip.
3. Remove front guide lower two adjusting stud nuts and loosen upper two nuts (see Fig. 7-36).
4. Rotate rear edge of glass upward until regulator lift arm roller is free of sash channel cam and two front glass rollers are out of front guide channels. Remove glass inboard of side rail.

NOTE: If additional clearance is needed, the side roof rail weatherstrip can be detached at quarter window area.

5. To install, reverse removal procedure. Figure 7-37 is an exploded view of the quarter window

assembly and identifies the various components and their assembly sequence.

ADJUSTMENTS—"X-37" Style

To perform any rear quarter window adjustments, it is necessary to remove the rear quarter trim assembly.

1. To adjust window "fore or aft", loosen front and rear guide adjusting stud nuts, position window and guides as required, and tighten nuts.
2. To adjust window "in or out" at belt line, loosen front guide upper adjusting stud nuts, adjust studs in or out as required, and tighten stud nuts.
3. To adjust top of window "in or out", loosen front guide lower adjusting stud nuts, adjust studs in or out as required, and tighten stud nuts.
4. To relieve a "fore or aft" binding condition between front and rear guides, loosen front

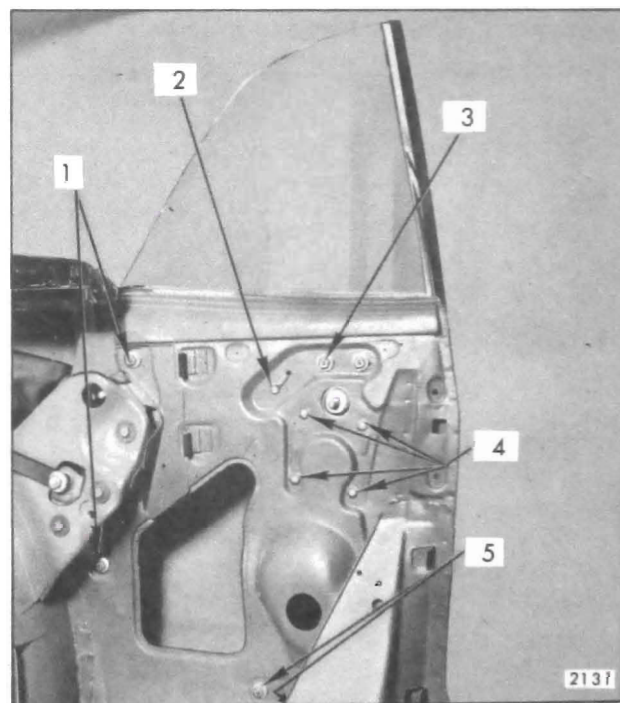

Fig. 7-26—Rear Quarter Hardware - "A-67" Styles

- | | |
|-----------------------------------------------|-----------------------------------------------|
| 1. Rear Guide Adjusting Studs and Nuts | 4. Regulator Bolts |
| 2. Up-Stop Bolt | 5. Front Guide Lower Adjusting Studs and Nuts |
| 3. Front Guide Upper Adjusting Studs and Nuts | |

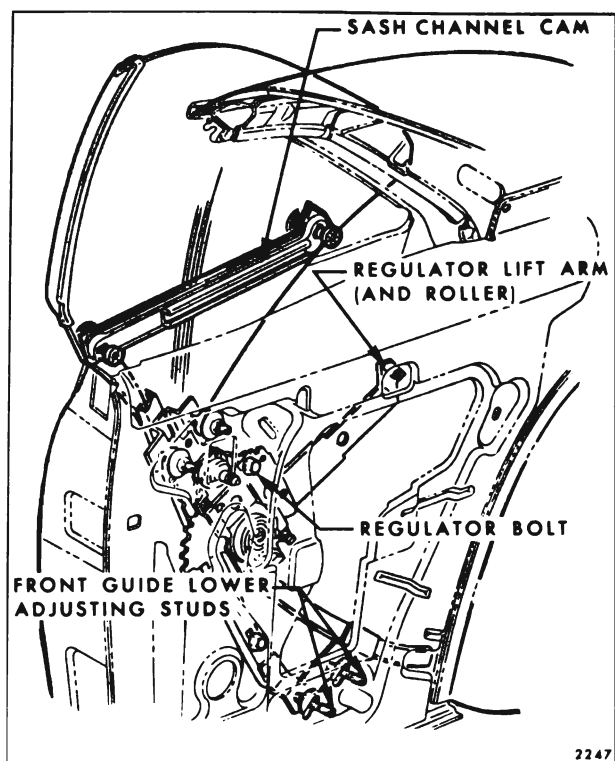

Fig. 7-27—Rear Quarter Window Removal - "A-17 and 67" Styles

and rear guide adjusting stud nuts. Operate window to "full-up" position and tighten upper adjusting stud nuts. Operate window to "full-down" position and tighten remaining stud nuts.

NOTE: When adjusting studs on front guide, make certain that adjacent studs are adjusted equally to prevent creation of a bind between cam channels.

5. To limit up-travel of window, adjust window stop as required (see Fig. 7-14).
6. The quarter window front guide is also equipped with an adjustable down-travel stop (see Fig. 7-14).

F. REMOVAL AND INSTALLATION— "Z-37" Styles

1. With window in full-up position, remove rear guide upper and lower attaching bolts (Fig. 7-38). Disengage guide from roller on window assembly and remove guide.
2. Remove regulator as described in a following procedure (see index).

3. Slide rear quarter window upward and forward and pivot top rear corner of glass to a point outboard of side roof rail. Continue movement of glass upward and forward to disengage front glass rollers from front guide assembly and remove rear quarter window from body.
4. To install, reverse removal procedure. Figure 7-39 is an exploded view of the quarter window assembly and identifies the various components and their assembly sequence.

ADJUSTMENTS—"Z-37" Styles

1. The quarter window up-stop can be utilized for adjustments of glass to side roof rail weather-strip (see Section "A-A" in Fig. 7-40).
2. The rear guide can be adjusted to gain proper fore and aft contact of rear quarter window vertical weatherstrip to rear edge of front door window (see section "C-C" and "F-F" in Fig. 7-40).

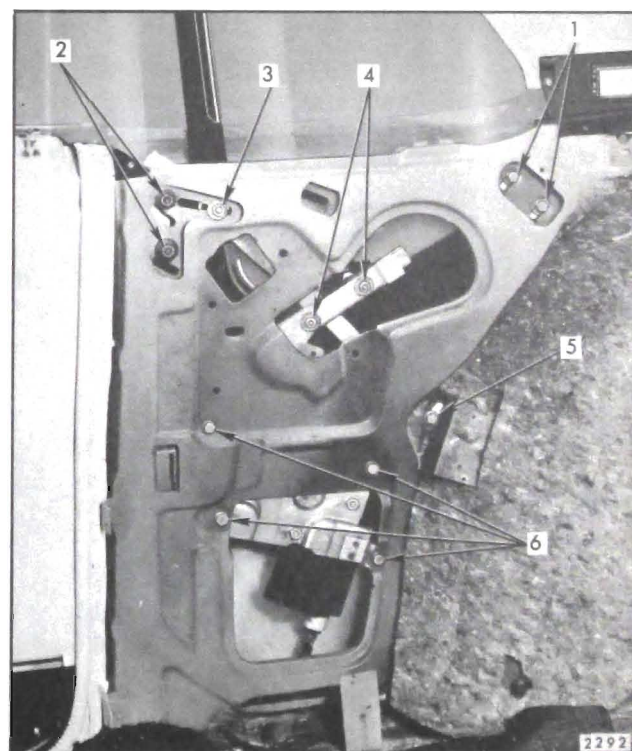

Fig. 7-28—Rear Quarter Hardware - "E" Body

- | | |
|-----------------------------------------------|-------------------------------------------------------------|
| 1. Rear Guide Attaching Bolts | 4. Regulator Lift Arm Cam Attaching Nuts |
| 2. Front Guide Upper Adjusting Studs and Nuts | 5. Front Guide Lower Attaching Bolt |
| 3. Up-Stop Attaching Bolts | 6. Regulator Attaching Bolts (4 for Electric, 5 for Manual) |

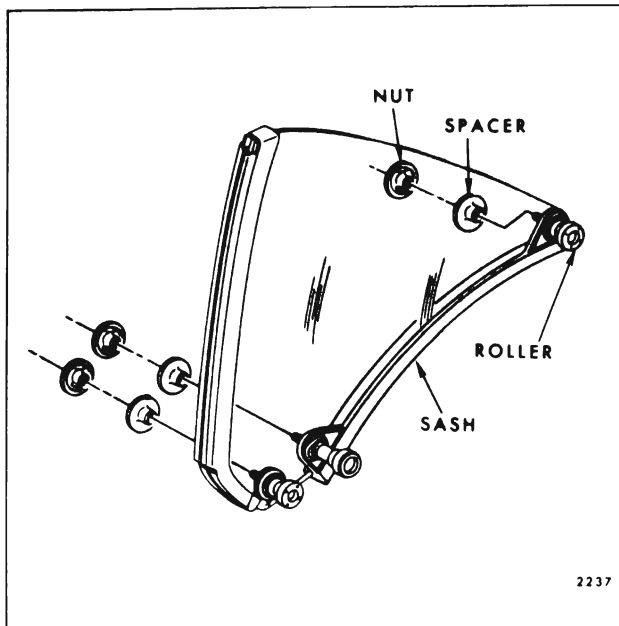

Fig. 7-29—Rear Quarter Window Assembly - "E-87" Styles

3. The upper two adjusting studs of the rear quarter window front guide are used for "in or out" and "fore or aft" adjustment of quarter window at front leading edge (see Section "D-D" in Fig. 7-40).
4. The lower two adjusting studs of rear quarter window front guide are adjustable "up or down" and "fore or aft" for proper operation of quarter window (see Section "E-E" in Fig. 7-40).
5. A secondary up-travel stop is located at forward end of sash channel cam (see Fig. 7-7).

REAR QUARTER WINDOW ASSEMBLY— "B-C 47-57-67-87" Styles

The rear quarter window assembly consists of a solid tempered safety plate glass window, a pressed-on front vertical sash channel and a bolt-on lower sash channel and cam assembly.

To service any of the component parts requires moving the entire window assembly from the body. Inaccessibility of the lower sash channel to glass attaching bolts prevents separation of glass from sash channel with window assembly installed.

Figures 7-41 and 7-42, which are exploded views of the "47" and "87" style quarter windows, are typical of all hardtop and convertible styles.

NOTE: When reinstalling lower sash channel and nylon rollers to quarter window, torque attaching nuts to 72 inch pounds (6 foot pounds). Also, replace sash channel and nylon roller rubber spacers.

Removal and Installation

1. Remove rear quarter trim assembly and inner panel water deflector or inner panel access hole cover. On "67" styles, lower folding top.
2. On "C-47" styles, remove roof rear drip molding (see "Molding" section) and quarter window rear vertical inner sealing strip assembly as described in a preceding procedure.

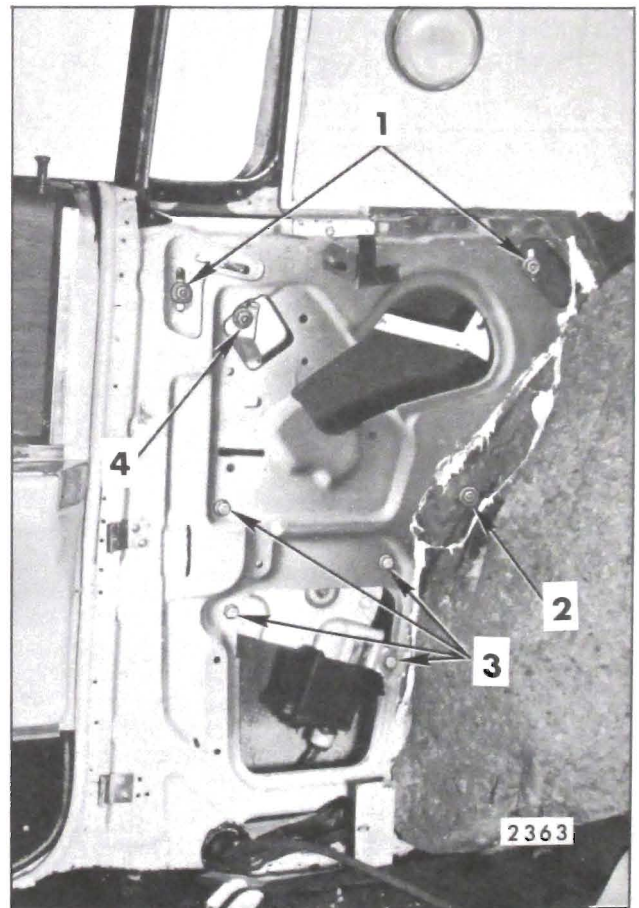

Fig. 7-30—Rear Quarter Hardware - "E-47" Styles

- | | |
|--------------------------------------------------|---------------------------------------------------------|
| 1. Inner Panel Cam Adjusting Studs and Nuts | 3. Regulator Attaching Bolts |
| 2. Glass Run Channel Rear Adjusting Stud and Nut | 4. Regulator Lift Arm to Cam Glass Roller Attaching Nut |

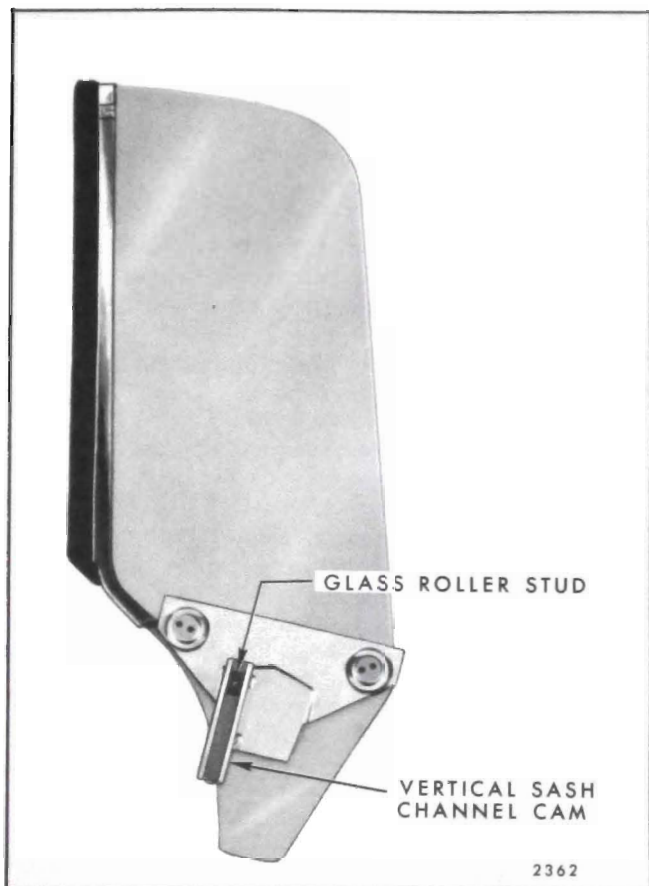

Fig. 7-31—Rear Quarter Window Assembly -
"E-47" Styles

3. With window in full-up position, remove rear guide adjusting stud nuts ("1", Fig. 7-43). Disengage guide from roller on window assembly and remove guide through access hole.
4. With window lowered to half-down position, remove front guide lower adjusting stud nuts "2", and loosen upper adjusting stud nuts "3". Push lower adjusting studs "2" outboard to disengage from slots in inner panel.
5. Grasping both window assembly and lower end of front guide, swing them forward sufficiently to disengage window regulator lift arm roller from lower sash channel cam at rear of cam.
6. Supporting window assembly, allow front guide upper adjusting studs "3" to drop to bottom of the slots provided in inner panel.
7. Remove window assembly by lifting upward and inboard.
8. To install, reverse removal procedure. Adjust window for proper alignment as described in following adjustment procedure.

Adjustments

1. Rear quarter window up-travel is determined by position of the window up stop "4" (Fig. 7-43). To change the window upper limits, loosen the stop attaching bolt and position the stop as desired.
2. Fore or aft position of the window is determined by the position of the front and rear guides. To adjust the window, loosen the front and rear guide adjusting stud nuts "1", "2" and "3" (Fig. 7-43) and reposition the window as required.
3. In or out adjustment of the window assembly, or only the top of the window, can be obtained by utilizing the front and rear guide adjusting studs (Fig. 7-43). To reposition the window in or out, adjust the guide upper and lower adjusting studs in the same direction. To adjust the top of the window in or out, adjust the lower adjusting studs in the opposite direction of the upper studs.

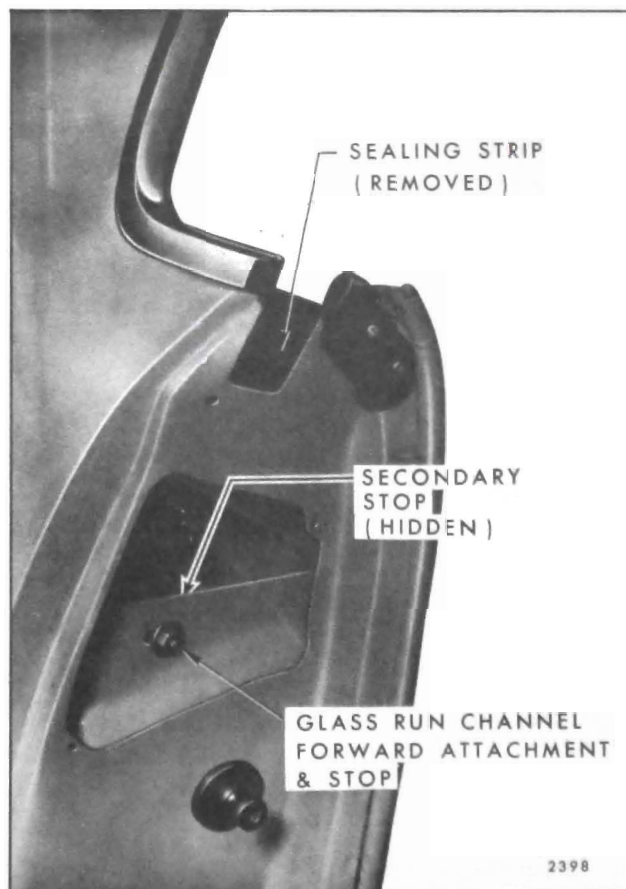

Fig. 7-32—Rear Quarter Window Hardware Attachments
on Lock Pillar

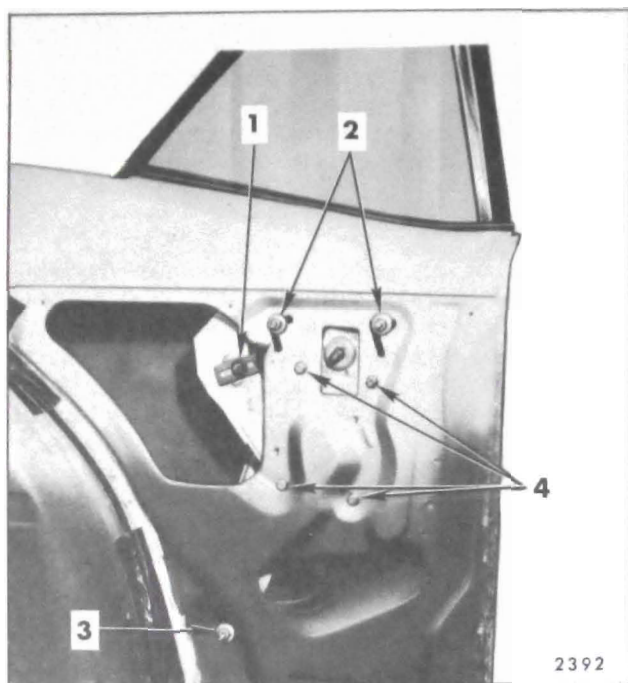

Fig. 7-33—Rear Quarter Window Hardware - "F" Styles

- | | |
|-------------------|---------------------------|
| 1. Window Up-Stop | 3. Window Guide |
| 2. Window Guide | Lower Adjusting |
| Upper Adjusting | Stud and Nut |
| Stud and Nuts | 4. Window Regulator Bolts |

4. To control the down-travel of the quarter window (fully lowered position), adjust the down travel stop. The down stop is located in the sash channel cam on "B-C 67" and "C-57" styles ("5", Fig. 7-43), and in the front guide on the remaining "B-C" hardtop styles as shown in Figure 7-44.

REAR QUARTER WINDOW REGULATOR (MANUAL OR ELECTRIC)— "B-C 47-57-67-87" Styles

Removal and Installation

1. Remove rear quarter trim assembly. On "67" styles remove inner panel access hole cover. On "47-57-87" styles, remove inner panel water deflector.
2. On "67" styles with electric window regulators, disconnect wire harness at in-line connector located inboard of inner panel. **DO NOT** attempt to disconnect permanent connector at motor. On "47-57-87" styles, disconnect wire harness connector at motor.

3. If window regulator failed with window in full-up position, proceed as follows:
 - a. Prop window in full-up position.
 - b. Remove window regulator attaching bolts "6", (Fig. 7-43).
 - c. Disengage regulator lift arm roller from lower sash channel cam at rear of cam and remove regulator through access hole.
4. If regulator failed with window in full-down position, proceed as follows:
 - a. Remove regulator attaching bolts "6" (Fig. 7-43).
 - b. Supporting window, move regulator forward to disengage lift arm roller at front of lower sash channel cam.

NOTE: On styles with down stop in cam ("5", Fig. 7-43), remove stop prior to disengaging regulator roller.

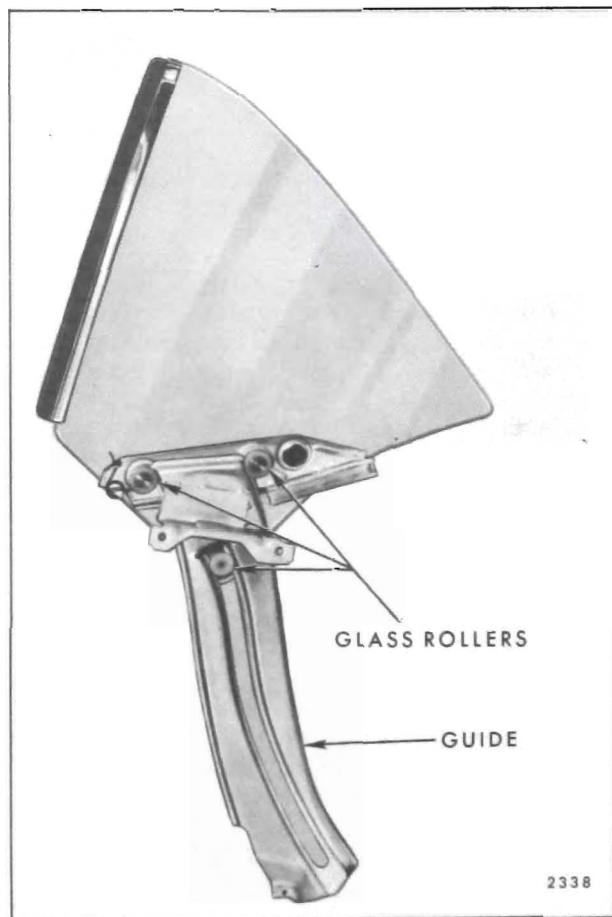

Fig. 7-34—Rear Quarter Window and Guide Assembly - "F" Styles

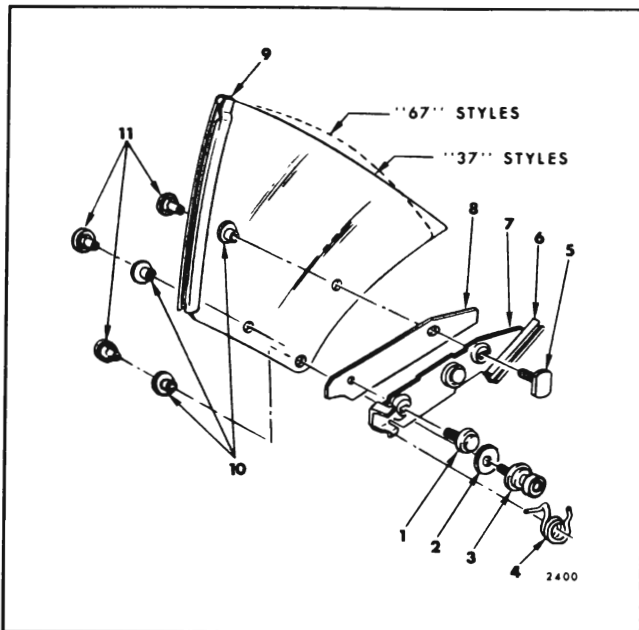

Fig. 7-35—Rear Quarter Window Assembly - "F" Styles

- | | |
|------------------------------------|-----------------------------------|
| 1. Lower Sash Channel Front Roller | 7. Lower Sash Channel |
| 2. Guide Roller Washer (Rubber) | 8. Lower Sash Channel Filler |
| 3. Guide Lower Roller | 9. Vertical Sash Channel |
| 4. Guide Roller Spring | 10. Glass to Sash Channel Bushing |
| 5. Glass to Sash Channel Bolt | 11. Glass to Sash Channel Nut |
| 6. Lower Sash Channel Cam | |

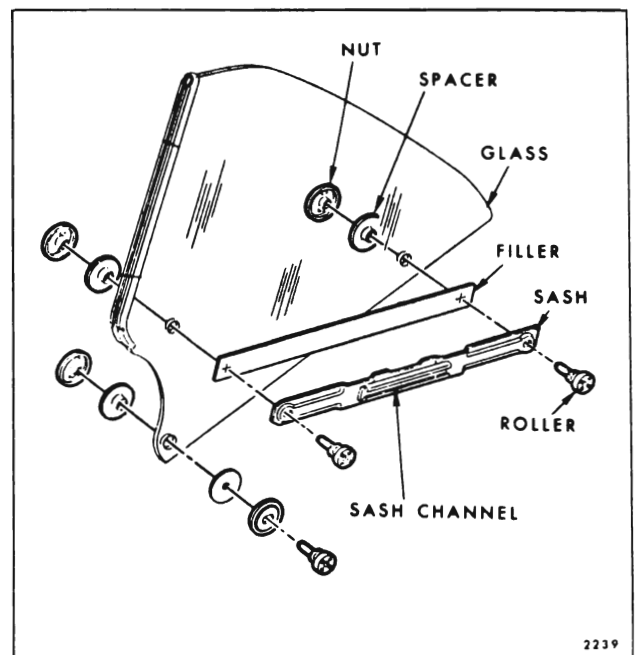

Fig. 7-37—Rear Quarter Window Assembly - "X-37" Style

- c. Manually raise window and prop in full-up position.
- d. Remove regulator through access hole.

5. To install, reverse removal procedure.

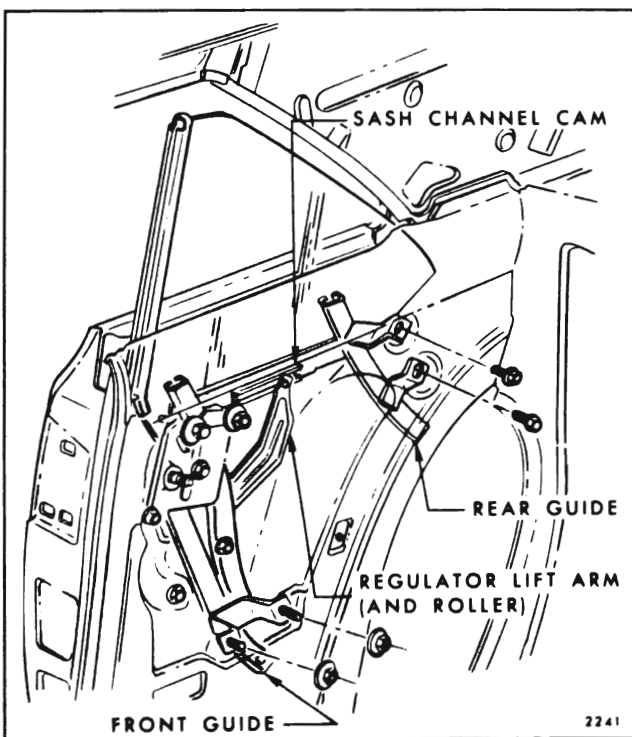

Fig. 7-36—Rear Quarter Hardware - "X-37" Style

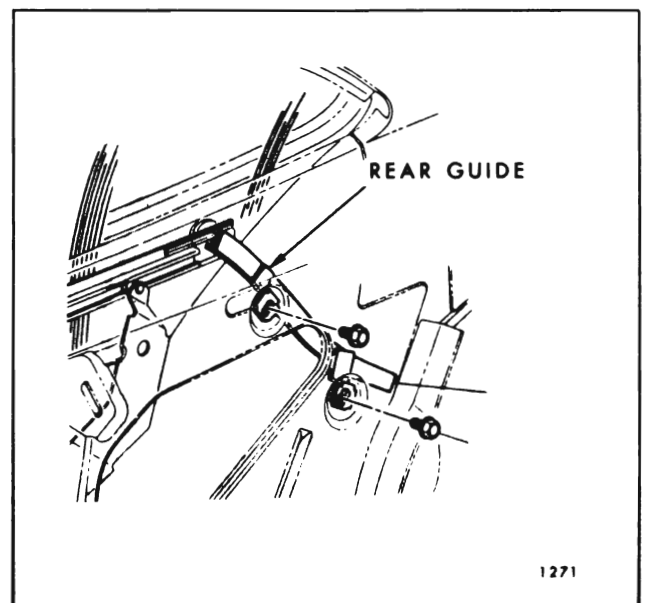

Fig. 7-38—Rear Quarter Window Rear Guide Assembly - "Z-37" Styles

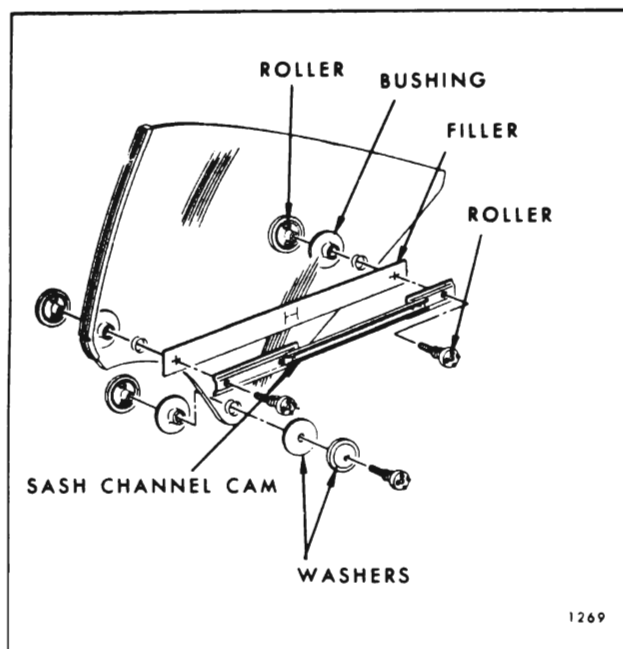

Fig. 7-39—Rear Quarter Window Assembly - "Z-37" Styles

REAR QUARTER WINDOW REGULATOR ASSEMBLY (MANUAL OR ELECTRIC)— "A, E, F, X & Z" Hardtop and Convertible Styles

Removal and Installation

1. Remove rear quarter trim assembly and inner panel access hole cover (or water deflector). On electric styles, disconnect feed wire from regulator or "in-line" connector.
2. On "E-87" styles, remove rear quarter window. On "A, X & Z-37" styles, prop window in a full-up position.
3. On "Z-37" styles, remove rear quarter window rear guide assembly.
4. On "E-47" styles, disconnect regulator lift arm from quarter window as described in "Rear Quarter Window Assembly" (see index).
5. Remove regulator to quarter inner panel attaching bolts, disengage lift arm roller from sash channel cam and remove regulator.

NOTE: If necessary, loosen upper attaching points of front guide to gain additional clearance.

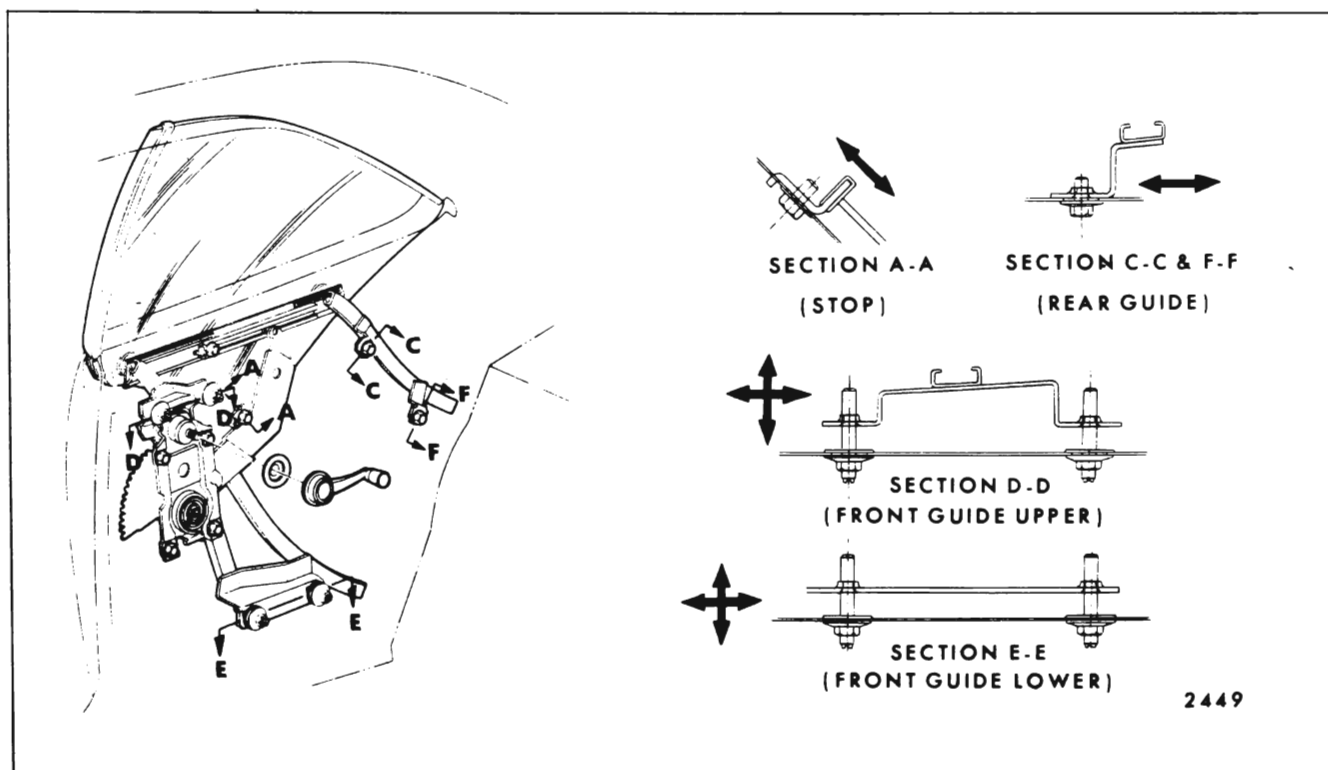

Fig. 7-40—Rear Quarter Window Adjustments - "Z-37" Styles (Arrows Indicate Adjustment Direction Available)

- To install, reverse removal procedure.

NOTE: The procedure for removing the electric motor from the regulator is described under "Door and/or Quarter Window Regulator Electric Motor Assembly".

REAR QUARTER WINDOW FRONT GUIDE—"B-C 47-57-67-87" Styles

Removal and Installation

- Remove rear quarter trim assembly and inner panel water deflector or access hole cover.
- With window in full-up position, remove front guide upper and lower adjusting stud nuts ("2" and "3", Fig. 7-43).
- Pull guide downward and rearward to disengage from rollers on window assembly and remove guide through access hole.
- To install, reverse removal procedure.

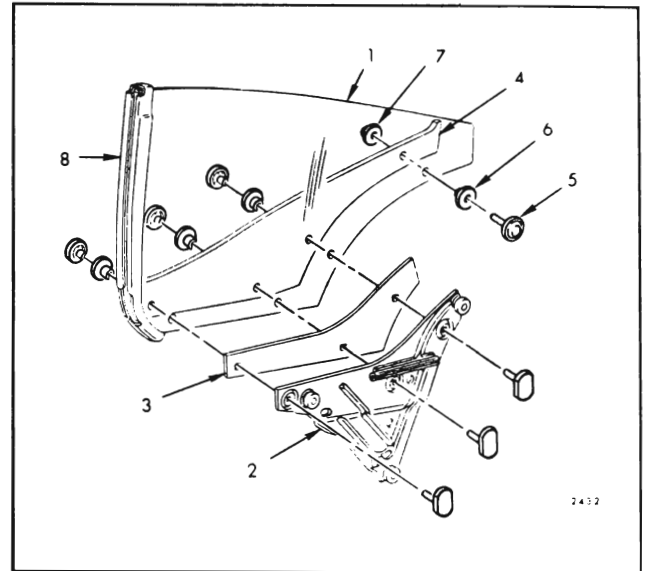

Fig. 7-41—Rear Quarter Window Assembly - "B-87" Styles

- | | |
|------------------------------------|------------------------------------|
| 1. Rear Quarter Window | 4. Lower Sash Channel Outer Filler |
| 2. Lower Sash Channel Assembly | 5. Bolt |
| 3. Lower Sash Channel Inner Filler | 6. Spacer |
| | 7. Nut |
| | 8. Front Vertical Sash Channel |

REAR QUARTER WINDOW FRONT GUIDE ASSEMBLY—"A-X-Z" Hardtop and Convertible Styles and "E-87" Styles

Removal and Installation

- Remove rear quarter window assembly.
- On "A, X & Z" styles, remove front guide upper and lower adjusting stud nuts (refer to Fig. 7-25 and 7-26. These illustrations are for "A" Bodies but are indicative of all styles).

NOTE: As explained under "Rear Quarter Window Assembly" - Removal and Installation for "E" bodies, the front guide attachments must be removed and guide lowered prior to removal of window assembly.

- Disengage guide adjusting studs from slots in quarter inner panel and remove guide through access hole on all except "E" styles. On "E" bodies, remove front guide between rear quarter inner and outer panels at belt.
- To install, reverse removal procedure. Adjust guide for proper window operation as specified under "Rear Quarter Window Adjustments".

NOTE: The rear channel of the front guide of most styles is equipped with an adjustable lower stop to control height of quarter window in the lowered position (see Fig. 7-44).

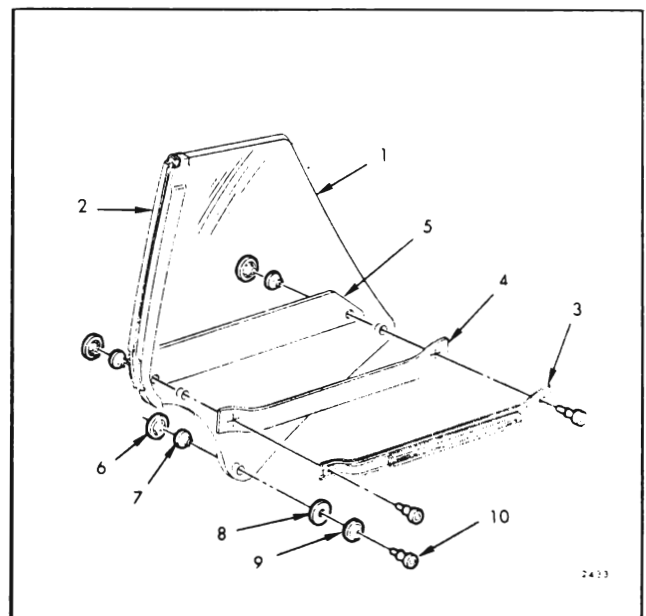

Fig. 7-42—Rear Quarter Window Assembly - "B-C-47-57-67" Styles

- | | |
|-----------------------------------------------------------|--------------------|
| 1. Rear Quarter Window | 6. Nut |
| 2. Front Sash Channel | 7. Spacer (Rubber) |
| 3. Lower Sash Channel | 8. Washer (Rubber) |
| 4. Lower Sash Channel Inner Filler | 9. Washer (Metal) |
| 5. Lower Sash Channel Outer Filler (Not on "B-57" Styles) | 10. Roller |

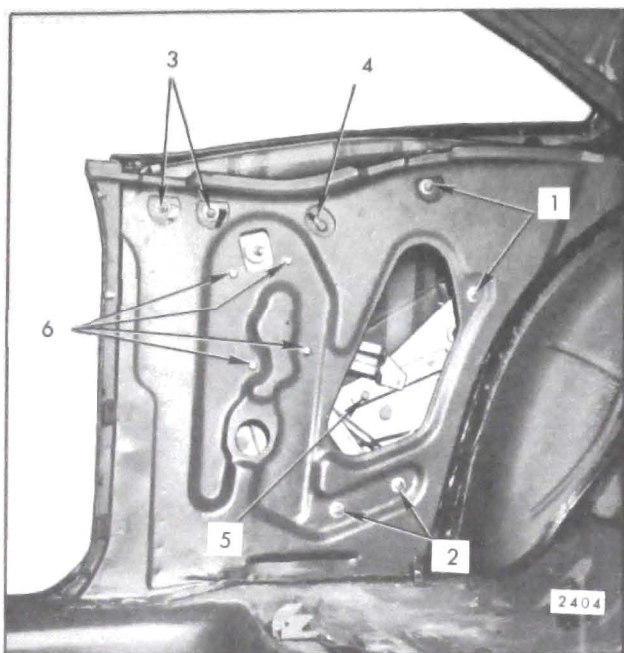

Fig. 7-43—Rear Quarter Hardware - "B-C" Coupe Styles

- | | |
|-----------------------------------------------|-----------------------------------------------------------------------------------------------------|
| 1. Rear Guide Adjusting Studs and Nuts | 4. Window Upper Stop |
| 2. Front Guide Lower Adjusting Studs and Nuts | 5. Window Lower Stop ("B-C-67" and "C-57" Styles Only - See Figure 7-44 for remaining Coupe Styles) |
| 3. Front Guide Upper Adjusting Studs and Nuts | |

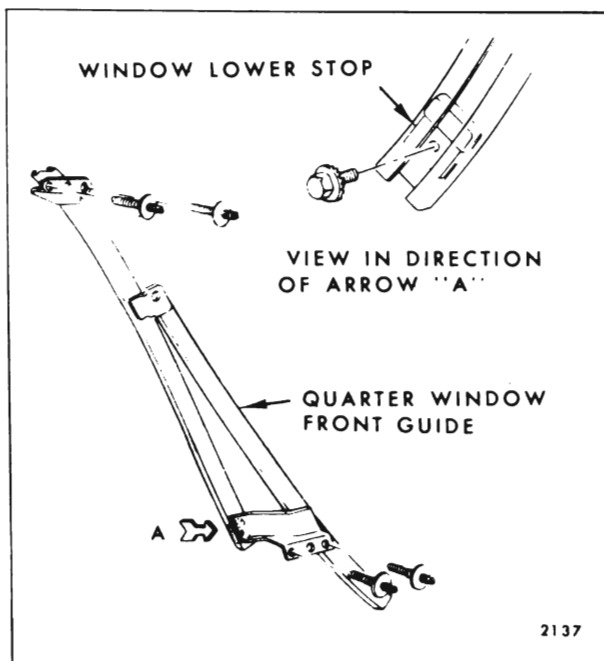

Fig. 7-44—Rear Quarter Window Lower Stop Adjustment - Styles so Equipped

REAR QUARTER WINDOW REAR GUIDE ASSEMBLY—"A-X-Z" Hardtop and Convertible Styles and "E-87" Styles

Removal and Installation

1. Remove rear quarter trim assembly and inner panel water deflector (or access hole cover).
2. As shown in Figures 7-36, 7-38, 7-25, 7-26 and all phantom views, rear guides are retained by two (2) bolts or adjusting studs. By providing a minimum of support for rear quarter window, these bolts or stud nuts can be removed and the guide disengaged from glass roller.
3. To install, reverse removal procedure. Adjust guide for proper window operation as specified under "Rear Quarter Window Adjustments".

REAR QUARTER WINDOW GUIDE ASSEMBLY—All "F" Styles

Removal and Installation

1. Remove rear quarter window regulator assembly.
2. Remove rear quarter window assembly.
3. Remove guide attaching nuts (3) and remove guide through large access hole (see Fig. 7-33).
4. To install, reverse removal procedure.

REAR QUARTER WINDOW GLASS RUN CHANNEL—"E-47" Styles

Removal and Installation

1. Remove rear quarter trim assembly and inner panel water deflector.
2. Remove lock pillar grille (see Fig. 7-32).
3. Remove run channel rear attachment (on inner panel - see Fig. 7-30) and forward attachment (under lock pillar grille).
4. With rear quarter window fully forward, remove glass run channel in a rearward motion.
5. To install, reverse removal procedure.